



APPROVED

1-90 FOR .050 MATERIAL

PRESTO-LOCK FASCIA SYSTEM

BUILT-UP OR MODIFIED VERSION

INSTALLATION INSTRUCTIONS

Installation Instructions For Modified Bitumen and Built-Up Roofing Systems

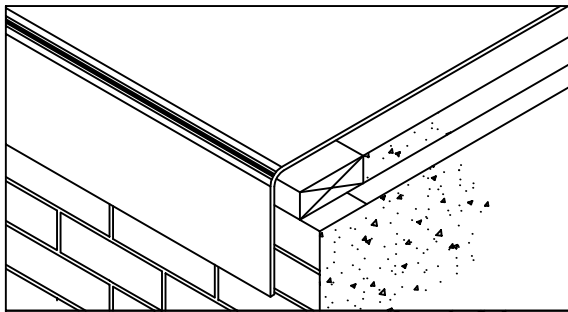

1. Built-Up or Modified Roofing

POSITION BASE SHEET OF THE BUILT-UP OR MODIFIED ROOF MEMBRANE OVER THE ROOF EDGE COVERING NAILER COMPLETELY.

NOTE: FOLLOW GENERAL RECOMMENDATIONS OF THE JOHNS-MANVILLE APPLICATION FOR THE MEMBRANE OVER THE EDGE.

CAUTION: TAKE EXTREME CARE TO AVOID SPILLAGE OF THE ASPHALT OVER THE EDGE.

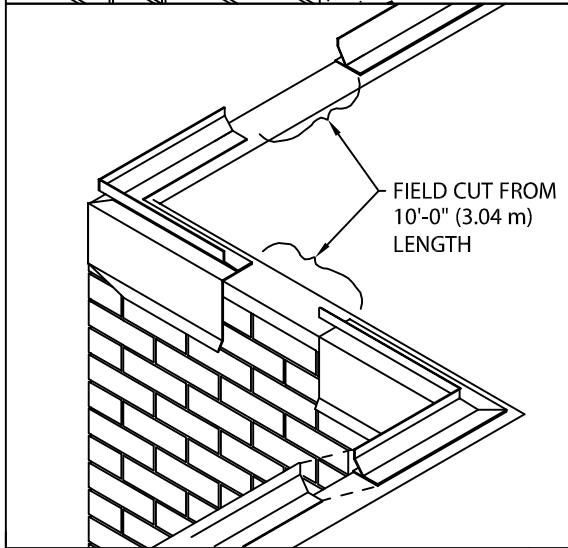

2. Waterdam

FIELD MAKE AND INSTALL WATERDAM CORNERS. NEXT INSTALL PRE-MANUFACTURED FASCIA SUMPS AND SCUPPERS. THEN INSTALL THE 10'-0" SECTIONS OF WATERDAM. WATERDAM IS NAILED 8" O.C. ON THE FACE AND 6" O.C. ON THE ROOF WITH ROOFING NAILS. FIELD CUT SECTIONS AS NECESSARY. SECTIONS SHOULD BE BUTTED TOGETHER.

MINIMUM WATERDAM FASTENERS: 1" GALV. ROOFING NAILS.

CAUTION: INSTALLERS SHALL WEAR PROTECTIVE EYE WEAR TO PREVENT SERIOUS INJURY.

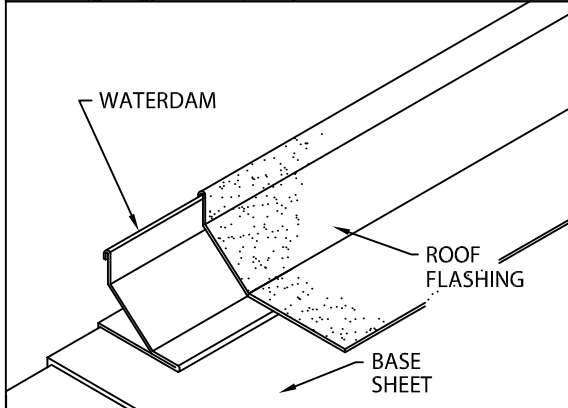

3. Roof Flashing

INSTALL FLASHING MATERIAL COMPATIBLE WITH ROOF MEMBRANE SYSTEM. TYPICAL ROOFING FLASHING IS CUT TO A 12" WIDTH. A MINIMUM OF 4" OF ROOF FLASHING IS FLASHED INTO MEMBRANE SYSTEM. EXTEND THE REST OF THE ROOF FLASHING UP THE WATERDAM AND DOWN ONTO THE SKIRT A MINIMUM OF 1". THE ROOF FLASHING MUST NOT BE BONDED TO THE WATERDAM.

APPROVED FLASHING MATERIALS FOR B.U.R. AND MODIFIED SYSTEMS:

DYNAFLEX AND GLASTITE FLEXIBLE. WHEN GLASTITE FLEXIBLE IS USED IT MUST BE COATED. SPM FLASHING FOR SPM SYSTEMS.

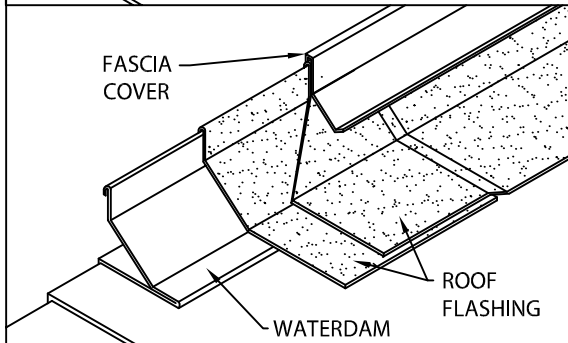

4. End Laps

MATERIAL SURFACED FLASHING MEMBRANE END LAPS CREATE A TOTAL THICKNESS THAT WILL NOT ALLOW EASE OF SNAPPING THE COVER PLATE IN PLACE. THEREFORE THE TOP LAPPED FLASHING SHOULD BE PUT ON BIAS AS SHOWN.



USA: 800-223-8317
Canada: 800-445-1500

DATE: 04/30/03

DRN BY: JWH

CKD BY: SAK

SHT.# 1 OF 2

DWG# 16110-2550

B



APPROVED
1-90 FOR .050 MATERIAL

PRESTO-LOCK FASCIA SYSTEM

BUILT-UP OR MODIFIED VERSION

INSTALLATION INSTRUCTIONS

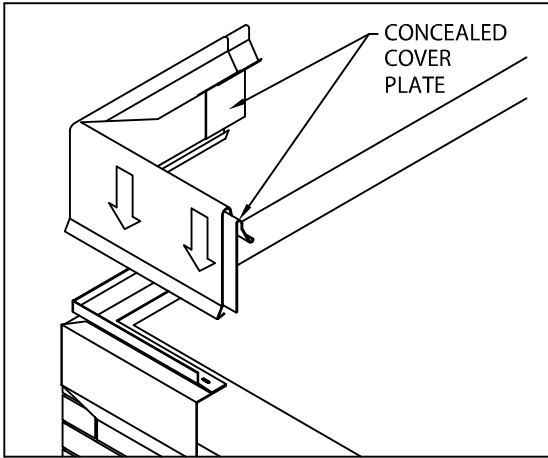

5. Fascia Miter Cover & Fascia Sump

INSERT CONCEALED COVER PLATES UNDER EACH END OF MITER COVER OR FASCIA SUMP. INSTALL MITER COVERS BY PUSHING DOWNWARD UNTIL "SNAP" OCCURS AND FASCIA COVER IS ENGAGED ALONG ENTIRE LENGTH OF MITER. FOR KYNAR OR ANODIZED COVER PLATES A 2" WIDE CONCEALED CLIP IS PROVIDED OF THE SAME COLOR. SLIDE THE 2" CONCEALED CLIP BEHIND CONCEALED COVER PLATE BEFORE INSTALLING THE 10'-0" COVER PLATES.

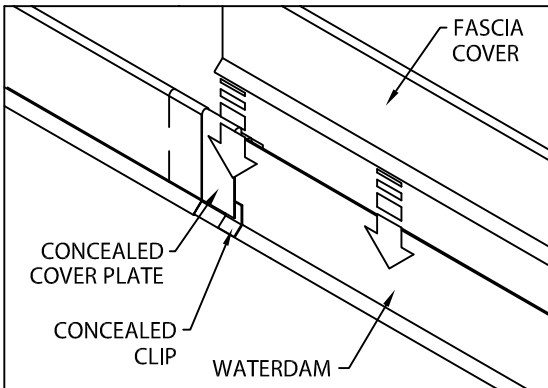

6. Fascia Covers / 10'-0" Lengths

INSTALL 10'-0" COVER PLATES BY INSERT ONE (1) CONCEALED COVER PLATE UNDER EACH END OF FASCIA COVER. INSTALL FASCIA COVER BY PUSHING DOWNWARD UNTIL FASCIA COVER IS ENGAGED TO THE WATERDAM ALONG ENTIRE LENGTH. THEN INSTALL 2" CONCEALED CLIP, IF NECESSARY. (ALLOW 1/2" GAP BETWEEN SECTIONS FOR THERMAL EXPANSION) FIELD CUT WHERE NECESSARY USING FINE TOOTH HACKSAW.

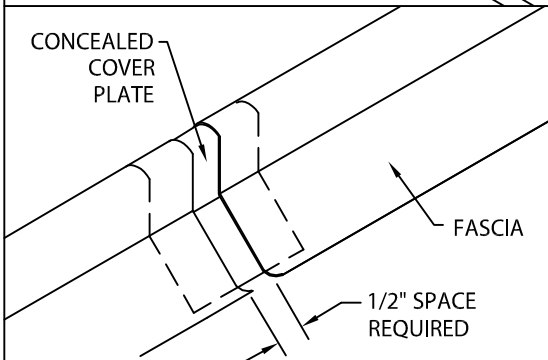

CAUTION: REMOVE PROTECTIVE FILM IMMEDIATELY BEFORE INSTALLATION, WHERE APPLICABLE.

TYPICAL INSTALLATION

