

PMR LOCK FASCIA

LIGHTWEIGHT PROTECTED MEMBRANE ROOFING VERSION

INSTALLATION INSTRUCTIONS

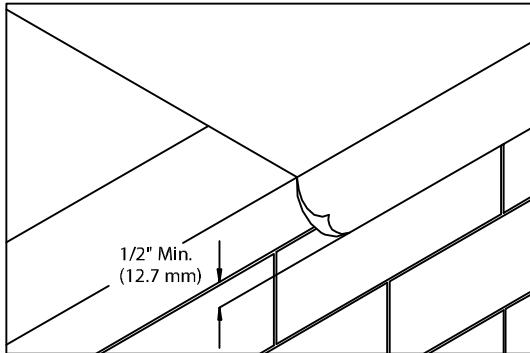

1. Roof Membrane

Position membrane over the roof edge and down outside face of wall, covering treated wood nailer(s) completely. Allow 1/2" (12.7mm) Minimum excess membrane.

IMPORTANT! Outside edge of treated wood nailer(s) (minimum 2 x 4) shall be aligned flush with or extend slightly past outermost edge of wall.

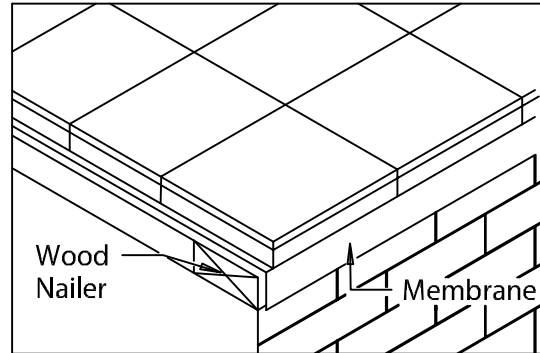

2. Ballast Paver

Layout pavers per Manufacturer's printed installation instructions. **IMPORTANT!** Carefully position the outside edge of the 1st row of Westile ballast pavers flush with the outside edge of the wood nailer.

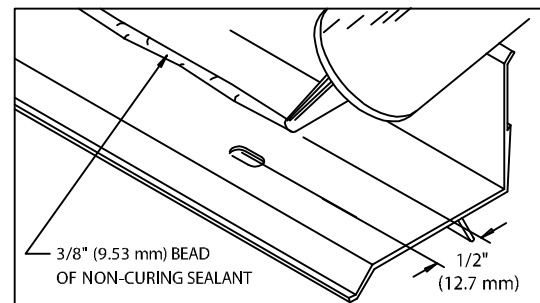

4. Miter & Scupper Anchor Bar (Preparation)

Lay miters and scuppers or sumps on deck with outside face down. Be sure aluminum anchor bar is clean and free of dirt or dust. Apply a heavy 3/8" (9.53 mm) bead of non-curing sealant to the back of anchor bar 1/2" (12.7 mm) above the slotted holes. Application of waterblock is required along the full length of each miter anchor bar.

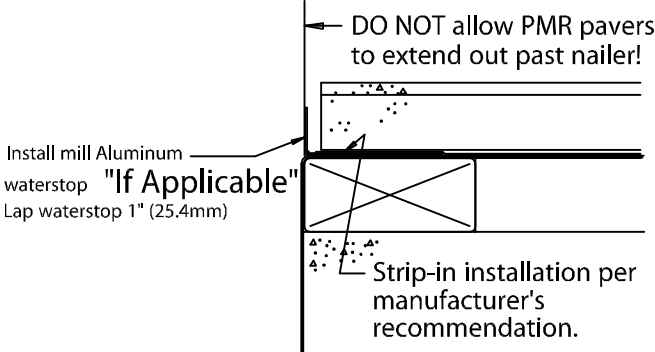

3. Ballast Paver (Cont.)

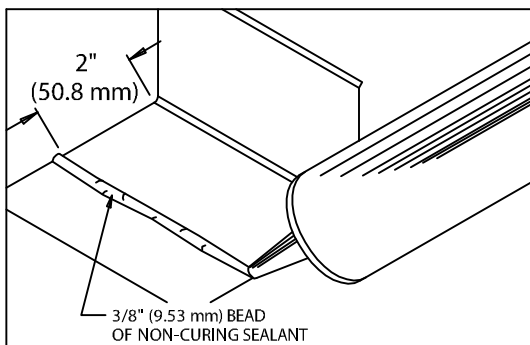

5. Anchor Bar Splice Plates

Apply Non-Curing Sealant to each splice plate as shown and described in STEP 4.

CAUTION! Installers shall wear protective eyewear to prevent injury. Do not over-drive fasteners, as stripping can occur at high driver torque. Recommended driving tool: 600 - 800 rpm electric drill equipped with depth-sensing nosepiece or adjustable torque control to prevent over-driving and stripout. Do not use impact type tool.

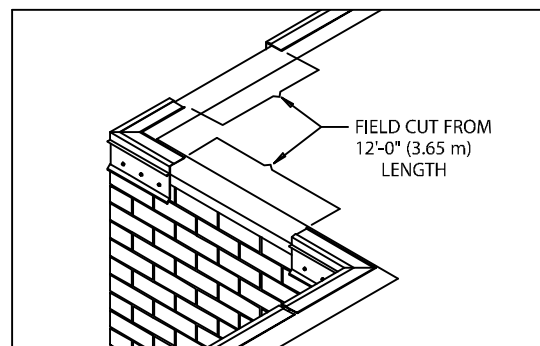

6. Miter Bar Installation

Fold roofing membrane at corners and install miters using 2" (50.8mm) stainless steel fasteners and driver bit furnished by Metal-Era. Fasten anchor bar corners to nailer with one splice plate under each end of corner.



Phone: 800-558-2162
Fax: 800-373-9156
www.metalera.com

DATE: 12/18/12
DRN BY: JJC
CKD BY: SAK

SHT.# 1 OF 2

DWG# 11110-1719

C

PMR LOCK FASCIA

LIGHTWEIGHT PROTECTED MEMBRANE ROOFING VERSION

INSTALLATION INSTRUCTIONS

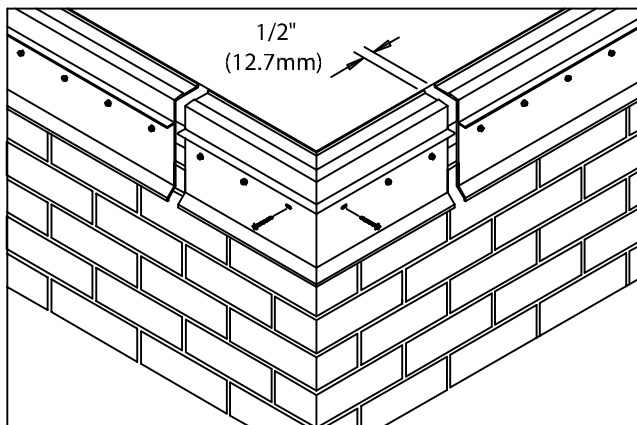

7. Anchor Bar (Installation)

Position 12'-0" (3.65M) sections of anchor bar with applied non-curing sealant as shown in steps 4 & 5 overlapping anchor bar splice plate. Allow 1/2" (12.7mm) space between anchor bars. Install anchor bar splice plate at other end of 12'-0" (3.65 M) bar. Fasten the anchor bar 12" (304.8mm) O.C. through the outside face slots using 2" (50.8mm) stainless steel fasteners provided. Field cut sections as necessary.

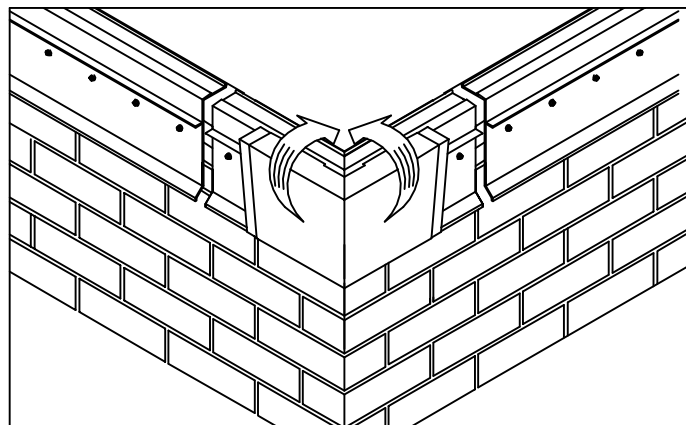

8. Fascia Miters Covers

Install miter covers first. Insert one fascia splice plate under each end of miter cover. Install miter covers by engaging miter cover onto anchor bar and rotating miter cover up and over anchor bar miter until engaged along entire length of the anchor bar.

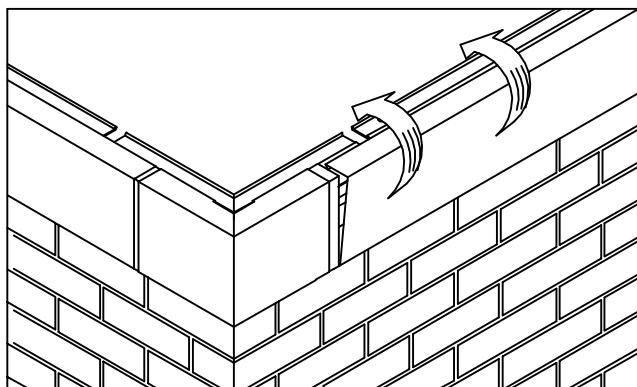

9. Fascia Covers

Install 12'-0" (3.65 m) fascia cover sections. Allow a 3/8" (9.53mm) gap between fascia cover sections. Insert one fascia splice plate under far end of each fascia cover section. Install cover by hooking lower edge of cover onto anchor bar and rotating cover up and over anchor bar until engaged along entire length of cover section. Continue to install cover sections in this manner, field cutting where necessary using a fine tooth hacksaw.

IMPORTANT! Be sure to remove protective plastic film prior to installing each fascia section.

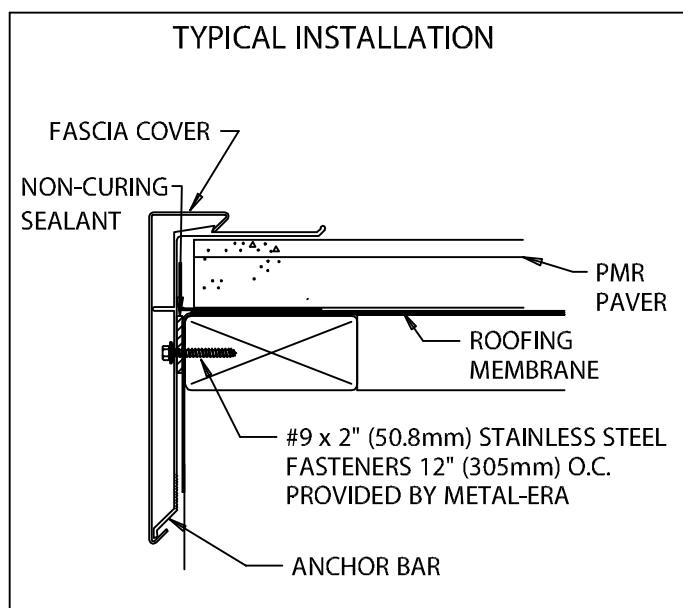

U.S. Patent # 4,665,667