

PRESTO-TITE DRIP EDGE

NOTES

- Fascia cover provided with lap joints
- For non-90 miters, see separate print approval
- Product should be installed per provided installation instructions
- ANSI/SPRI/FM 4435/ES-1 Test Pressure up to 98 psf

FLAT ROOF FLANGE

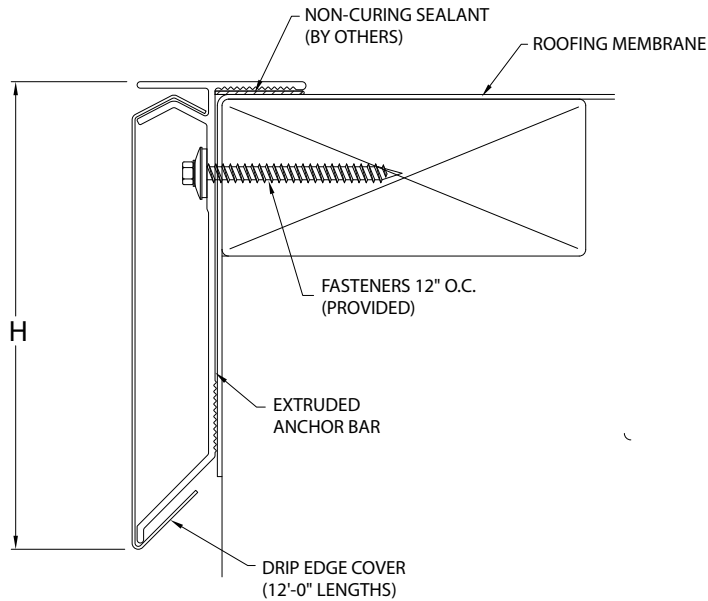

PITCHED ROOF FLANGE

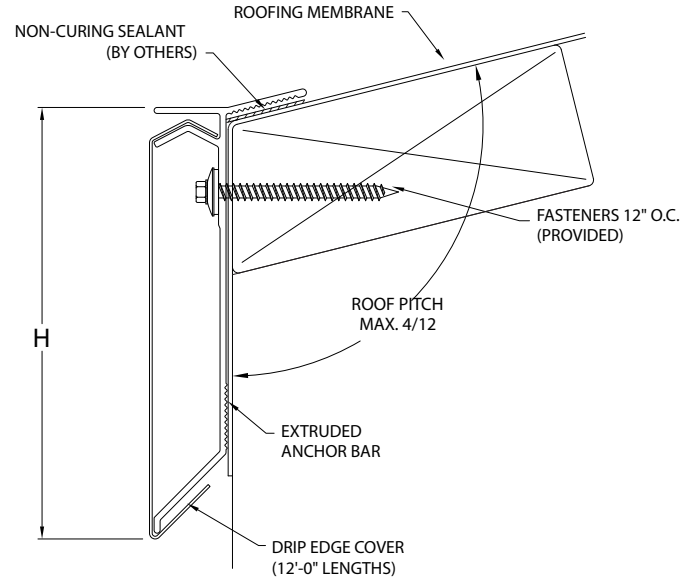

APPROVALS



ANSI/SPRI/FM 4435/ES-1
Test Pressures listed in notes

PROJECT INFO

Project Name: _____

Architect: _____

Roofing Contractor: _____

Project Type: _____

☐ By selecting this box you have verified and confirmed that dimensions, sizes, and quantities are correct. All products will be installed in strict accordance with printed instructions.

Date: _____

Johns Manville

EdgeMetal@jm.com

Main JM Switchboard USA:

303-978-2000

Technical: 800-922-5922 Option 3

Account Specialists: 877-766-3295

General Product Information

Center: 800-654-3103

SHT# _____ of _____

DATE: **07/10/24**

DRN BY: **MM**

CKD BY: **MM**

DWG #: 16010-42510

REV: **A**

DIMENSIONS

PRODUCT ID. NO.	H DIM	ROOF FLANGE (SELECT ONE)
ADE-30	3"	<input type="checkbox"/> FLAT <input type="checkbox"/> PITCHED <div>ROOF PITCH</div> <div>MAX. 4/12 PITCH</div>
ADE-45	4 1/2"	
ADE-60	6"	
ADE-75	7 1/2"	

MATERIAL

- ☐ 24 Ga. Galv. Steel
☐ 22 Ga. Galv. Steel
☐ .040" Aluminum

Color: _____

Finish: _____

Substrate: ☐ Wood
☐ Masonry
☐ Metal
If substrate is not given, wood fasteners will be provided.

☐ OTHER: _____

QUANTITIES

_____ Lineal Feet (12'-0" Lengths)

_____ Outside Miter (90°)

_____ Inside Miter (90°)

_____ Right Endcap

_____ Left Endcap