

PMR TERMINATION BAR

LIGHTWEIGHT PROTECTED MEMBRANE ROOFING VERSION

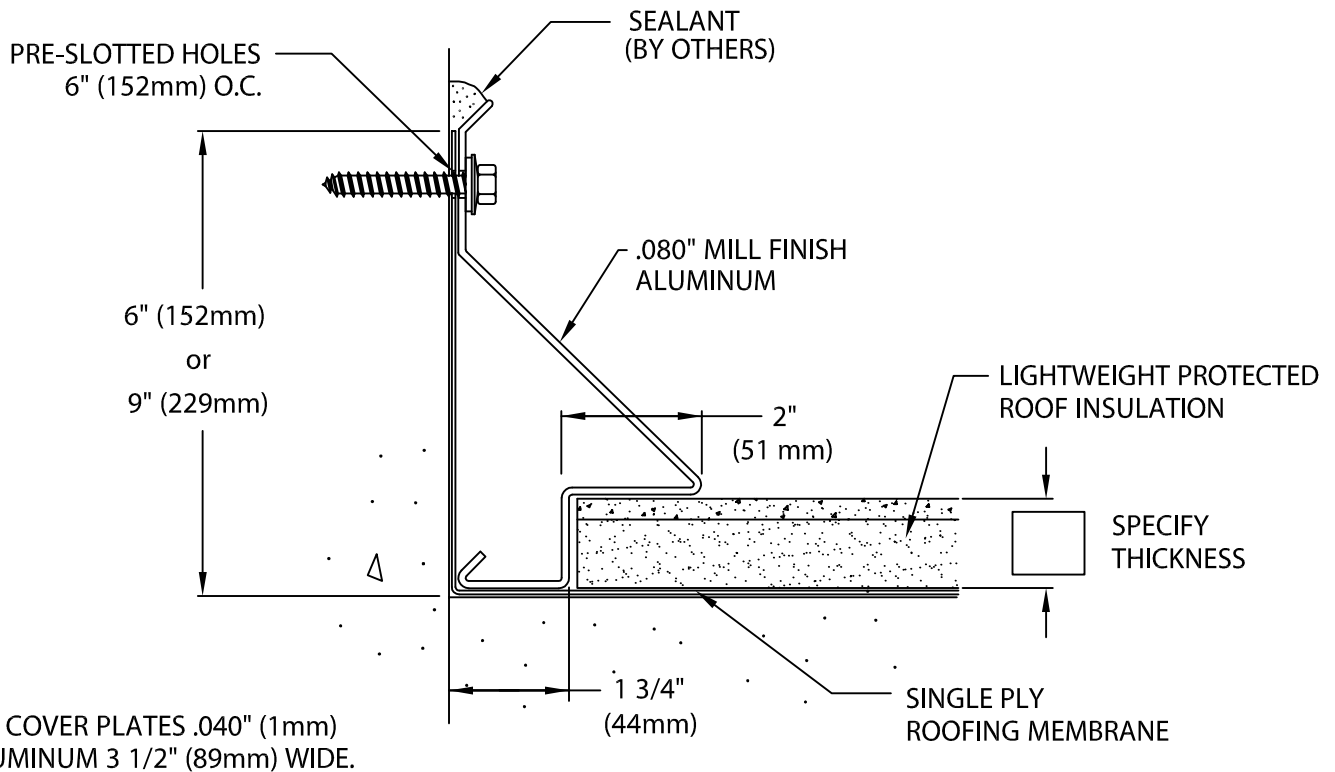

Termination Bar is to be installed per Specifications and Metal-Era's Installation Instructions Dwg. # 11116-1703

NOTE: Fasteners by others. Use appropriate fasteners as recommended by membrane manufacturer to maintain constant compression seal.

Fabrication will proceed only after receipt of signed print approval.

Print Approval:

Architect and/or contractor shall verify all dimensions, sizes and quantities. All products to be installed in strict accordance with Metal-Era's printed instructions.

Approved by: _____

Date: _____

DIMENSIONS:

___ PL-660 - 6" (152 mm)

___ PL-690 - 9" (229 mm)

QUANTITIES:

_____ Lineal Feet (12'-0" (3.65 M) Lengths)

_____ Welded Outside Miters (____°)

_____ Welded Inside Miters (____°)

PROJECT:

ARCHITECT:

ROOFING CONTRACTOR:

REPRESENTATIVE/DISTRIBUTOR:

Corporate Offices, Manufacturing
1600 Airport Road; Waukesha, WI 53188
Phone: 800-558-2162
Fax: 800-373-9156
www.metalera.com



DATE: 06/01/08

DRN BY: JJC

CKD BY: SAK

SHT.# ____ OF ____

DWG# 11016-1611

C