

OUTSIDE "T" MITERS

RIGHT OUTSIDE "T" MITER

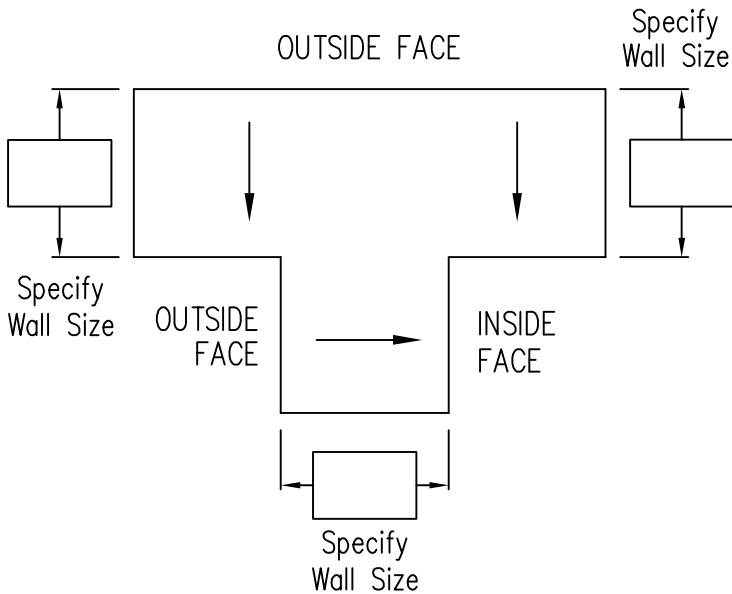

LEFT OUTSIDE "T" MITER

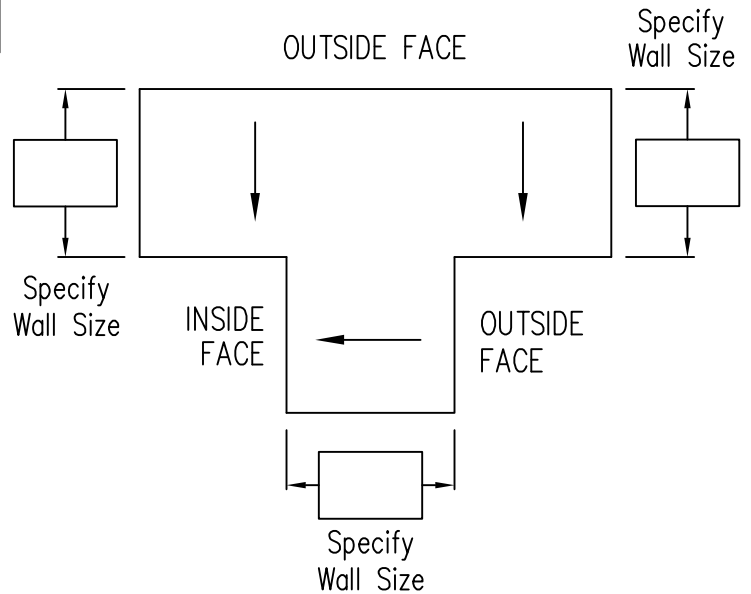

NOTES: -- Concealed splice plates are provided with factory applied dual non-curing sealant strips.

-- Unless otherwise noted, fabrication of miters and accessories are furnished standard utilizing a non-penetrating "Quicklock" joint, then factory sealed watertight.

Fabrication will proceed only after receipt of signed print approval.

Print Approval:

Architect and/or contractor shall verify all dimensions, sizes, and quantities. All products to be installed in strict accordance with Carlisle SynTec, Inc. printed instructions.

Approved by: _____

Date: _____

-- Welded Miters and Accessories

Check one Required (surcharge) Not applicable

MATERIALS:

___ 24 GA. (.65 mm) Steel

___ .040" (1.01 mm) Alum. Color: _____

___ .050" (1.27 mm) Alum.

___ .063" (1.60 mm) Alum. Finish: _____

___ Other _____

QUANTITIES:

___ Right Outside "T" Miters

___ Left Outside "T" Miters

SECUREDGE 200 COPING

Tapered

Flat

PROJECT

ARCHITECT

ROOFING CONTRACTOR

REPRESENTATIVE/DISTRIBUTOR

Customer Service
888-666-4369
(Metal-Era)



DATE: 02/19/08

DRN BY: JJC

CKD BY: SAK

SHT.# ___ OF ___

DWG# 15011-1682

B