

OUTSIDE
FACE

OUTSIDE FACE HEIGHT

SPECIFY
DIMENSION

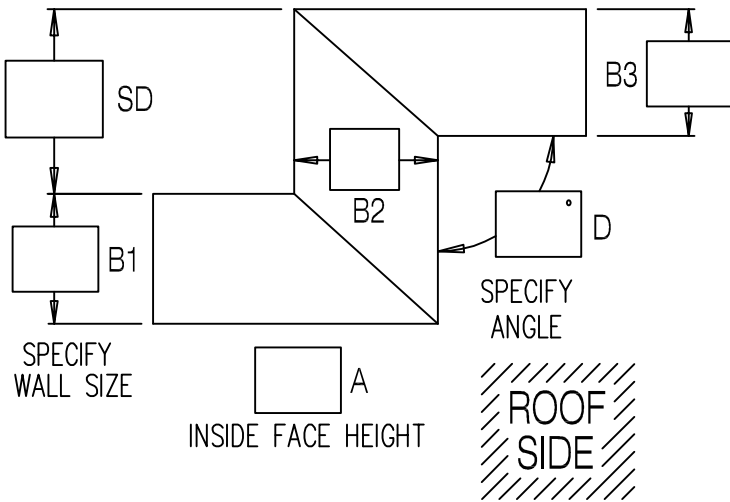

R.H. QUANTITY. _____

- STANDARD LEG LENGTHS
 CUSTOM LEG LENGTHS _____

OUTSIDE
FACE

OUTSIDE FACE HEIGHT

SPECIFY
WALL SIZE

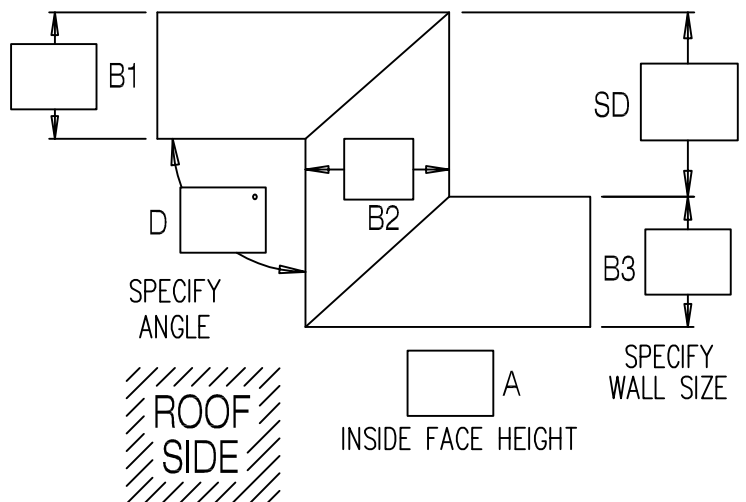

L.H. QUANTITY. _____

- STANDARD LEG LENGTHS
 CUSTOM LEG LENGTHS _____

NOTES: -- Concealed splice plates are provided with factory applied dual non-curing sealant strips.
 -- Unless otherwise noted, fabrication of miters and accessories are furnished standard utilizing a non-penetrating Quicklock Joint, then factory sealed watertight.

Fabrication will proceed only after receipt of signed print approval.

Print Approval:

Architect and/or contractor shall verify all dimensions, sizes, and quantities. All products to be installed in strict accordance with Sika Sarnafil printed instructions.

Approved by: _____

Date: _____

-- Welded Miters and Accessories

Check one Required (surcharge) Not applicable

MATERIAL:

- ____ 24 GA. (.65 mm) STEEL
 ____ .040" (1.01 mm) ALUMINUM
 ____ .050" (1.27 mm) ALUMINUM
 ____ .063" (1.60 mm) ALUMINUM
 ____ OTHER _____

COLOR: _____

FINISH: _____

____ SMOOTH ____ FLAT

QUANTITIES:

____ Right Hand Miters

____ Left Hand Miters

Tapered Flat

PROJECT

ARCHITECT

ROOFING CONTRACTOR

REPRESENTATIVE/DISTRIBUTOR

Sika Sarnafil Inc.
 100 Dan Road
 Canton, MA 02021
 (800) 451-2504
 Fax: (781) 828-5365



Sarnafil®

DATE: 06/01/02

DRN BY: COB

CKD BY: SAK

SHT.# _____ OF _____

DWG# 14011-2863 **A**