



2 1/2" MIN. OR 5 1/2" MIN.
DEPENDING ON SIZE
OF T-BAR FLANGE

ISOLATION LAYER
(EXAMPLES OF
ISOLATION LAYER
WOULD BE PEEL AND
STICK MEMBRANE,
RUBBER STRIPS, PLASTIC
STRIPS OR ELECTRICAL TAPE

1/2" MIN.

1. ISOLATION LAYER
PLACE CONTINUOUS ISOLATION LAYER BETWEEN EXTRUDED BAR AND SUBSTRATE TO REDUCE CORROSION BETWEEN TREATED WOOD (ACQ) OR CONCRETE. NO ISOLATION LAYER IS REQUIRED BETWEEN EXTRUDED BAR AND METAL DECK OR NON-TREATED LUMBER.

ROOF SIDE

CUT AT ANGLE AND FASTEN TO WALL

2. OUTSIDE MITER FABRICATION
CUT A PIECE OF ELIMINAILER T (ANY LENGTH) ON AN ANGLE. FASTEN TO WALL AT CORNER WITH PROVIDED FASTENERS.

CUT AT ANGLE AND FASTEN TO WALL

ROOF SIDE

3. OUTSIDE MITER FABRICATION
CUT A SECOND PIECE OF ELIMINAILER T (ANY LENGTH) ON AN ANGLE TO FORM A COMPLETE MITER. FASTEN TO WALL AT CORNER WITH PROVIDED FASTENERS.

ROOF SIDE

4. INSIDE MITERS
NO BAR CUTTING IS NEEDED FOR INSIDE MITERS. SIMPLY BUTT FULL SIZE BARS TIGHT INTO CORNER AND FASTEN TO WALL WITH PROVIDED FASTENERS.



polyglass.us
1111 West Newport Center Drive
Deerfield Beach, FL 33442
Technical Service: (866) 794-9659
technical@polyglass.com

DATE: 03/02/22
DRN BY: MLM
CKD BY: MM

SHT.# 1 OF 2
DWG# 45118-37601 **A**

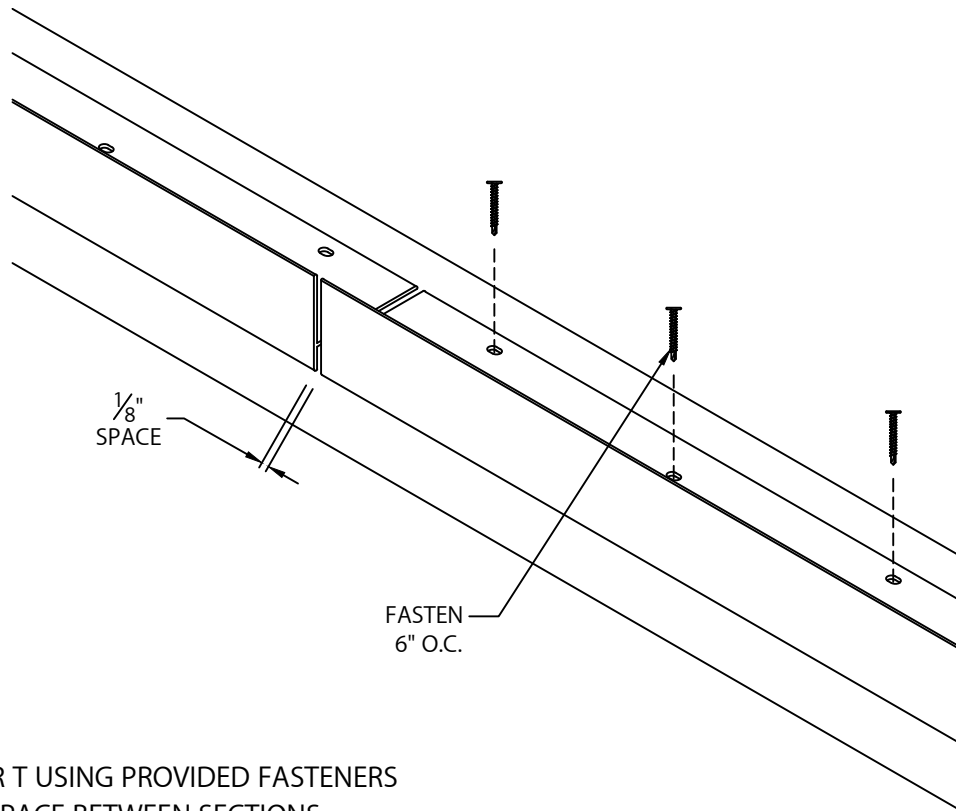

5. ELIMINAILER T

FASTEN ELIMINAILER T USING PROVIDED FASTENERS
6" O.C. LEAVE A 1/8" SPACE BETWEEN SECTIONS.

TYPICAL INSTALLATION FOR USE WITH EXISTING WOOD NAILER

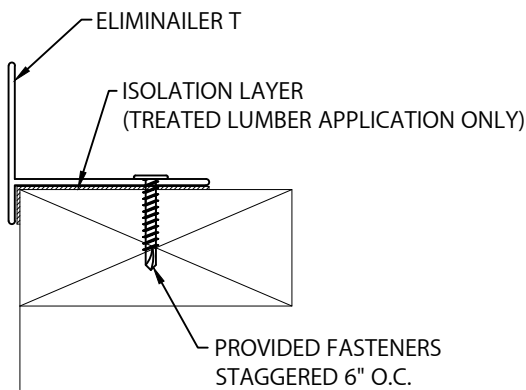

TYPICAL INSTALLATION FOR USE WITH METAL DECK OR MASONRY WALL

