



FIBERTITE WR GUTTER
OFFSET

FM DESIGN

*NOTES

- Bottom sizes are provided in 1/2" increments
- Maximum downspout dimension not to exceed "B" minus 1- 9/16"
- Roof flange is optional. If flange size is not provided, the gutter will not include a roof flange. If flange angle not provided, the gutter will have a 90-degree flange.
- Pop rivets provided
- Unless otherwise noted, fabrication of miters and accessories are provided with a non- penetrating quicklock joint, then factory sealed watertight
- Welded accessories require minimum material thickness of .050 aluminum.
- For non-90 miters, see separate print approval
- Product should be installed per provided installation instructions
- ANSI/SPRI/GT-1 test pressures up to 596 psf (Horizontal), 224 psf (Vertical), 160 plf (Downward)

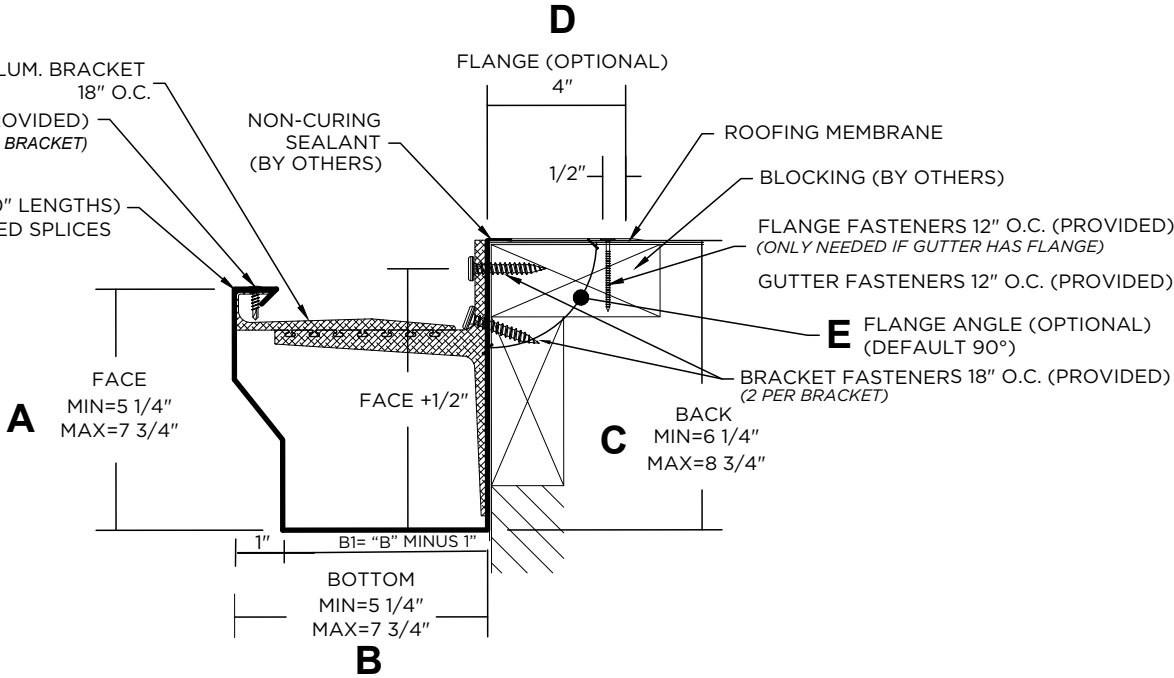

APPROVALS*



ANSI/SPRI/GT-1

Test Pressures listed in notes

PROJECT INFO

Project Name:

Architect:

Roofing Contractor:

Project Type:

By selecting this box you have verified and confirmed that dimensions, sizes, and quantities are correct. All products will be installed in strict accordance with printed instructions.

Date:

FiberTite
Customer Service
1-800-355-6416

SHT# of

DATE: 06/03/25

DRN BY: MLM

CKD BY: MM

DWG #: 23012-44778

REV: A

DIMENSIONS

SELECT SIZE	A (FACE)	B (BOTTOM)	C (BACK)	FLANGE (OPTIONAL)
<input type="checkbox"/>	5 1/4"	5 1/4"	6 1/4"	D (FLANGE) PLEASE SELECT ONE: WITH FLANGE <input type="checkbox"/> WITHOUT FLANGE <input type="checkbox"/> <small>NOTE: IF NEITHER BOX IS CHECKED, THE GUTTER WILL BE PROVIDED WITHOUT A ROOF FLANGE</small>
<input type="checkbox"/>	5 3/4"	5 3/4"	6 3/4"	
<input type="checkbox"/>	6 1/4"	6 1/4"	7 1/4"	
<input type="checkbox"/>	6 3/4"	6 3/4"	7 3/4"	
<input type="checkbox"/>	7 1/4"	7 1/4"	8 1/4"	
<input type="checkbox"/>	7 3/4"	7 3/4"	8 3/4"	
				E (FLANGE ANGLE) <small>NOTE: IF ANGLE IS NOT PROVIDED, FLANGE WILL BE 90°</small>

MATERIAL

- ☐ 24 Ga. Galv. Steel
☐ 22 Ga. Galv. Steel
☐ .040" Aluminum
☐ .050" Aluminum
☐ .063" Aluminum
☐ OTHER: _____

Color: _____

Finish: _____

Substrate:

If substrate is not given, wood fasteners will be provided.

- ☐ Wood
☐ Masonry
☐ Metal

Accessory Type*: ☐ Quicklock (Default) ☐ Welded (Surcharge)

QUANTITIES

- _____ Lineal Feet (12'-0" Lengths)
_____ Outside Miter (90°)
_____ Inside Miter (90°)
_____ Right Endcaps
_____ Left Endcaps
_____ Expansion Joints (If Required)



FIBERTITE WR GUTTER

OFFSET STANDARD ACCESSORIES

FM DESIGN

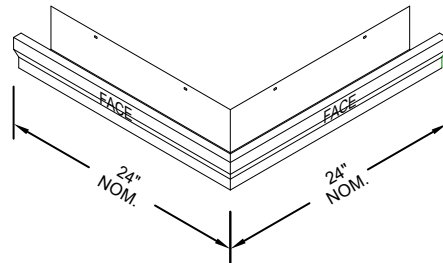
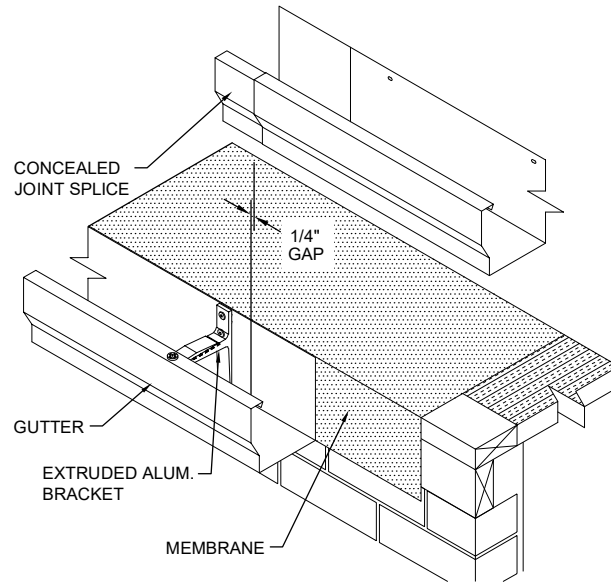

OUTSIDE MITER

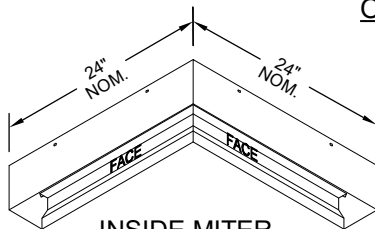

INSIDE MITER

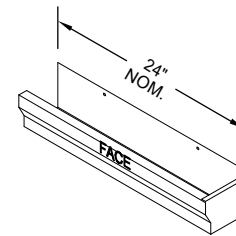

END CAP
LEFT HAND SHOWN

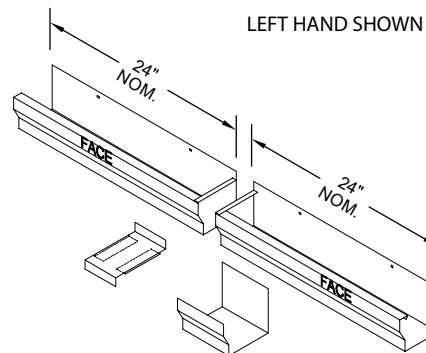

EXPANSION JOINT
(IF REQUIRED)

Standard gutter miter leg lengths are 24" Nominal
Standard gutter miter angle is 90°
For special miter requirements, attach sketches or consult manufacturer for assistance.

SHT# ____ of ____

DATE: 06/03/25

DRN BY: MLM

CKD BY: MM

DWG #: 23012-44778

REV: A

FiberTite
Customer Service
1-800-355-6416