

# SOPREMA SENTINEL DRIP EDGE

WITH FACTORY APPLIED PVC FLASHING AND CONTINUOUS CLEAT

NOTE: INSTALL MITERS FIRST

INSTALLATION INSTRUCTIONS

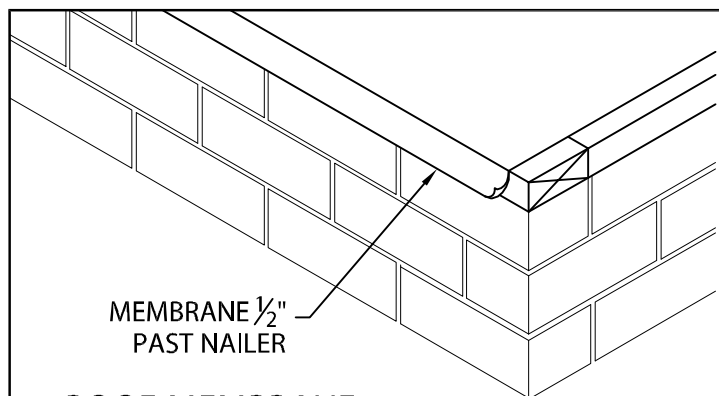

## 1. ROOF MEMBRANE

POSITION MEMBRANE OVER THE ROOF EDGE AND DOWN OUTSIDE FACE OF WALL, COVERING WOOD NAILER(S) COMPLETELY. ALLOW  $\frac{1}{2}$ " EXCESS MEMBRANE.

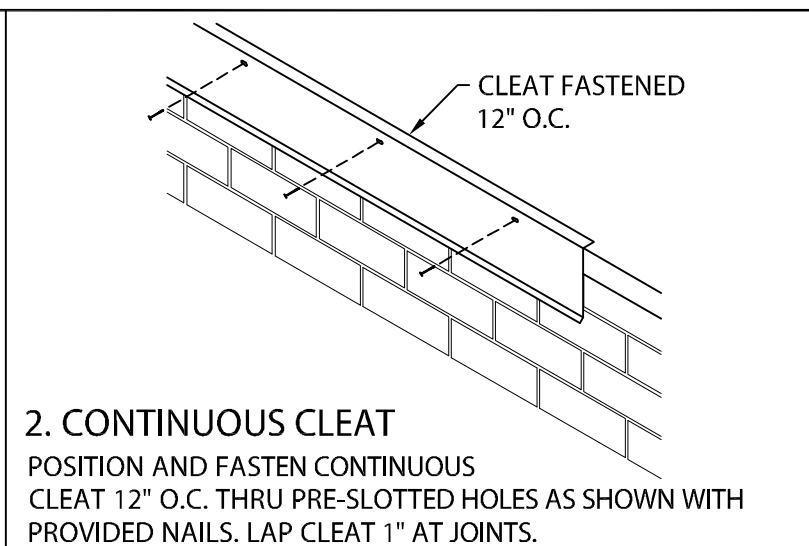

## 2. CONTINUOUS CLEAT

POSITION AND FASTEN CONTINUOUS CLEAT 12" O.C. THRU PRE-SLOTTED HOLES AS SHOWN WITH PROVIDED NAILS. LAP CLEAT 1" AT JOINTS.

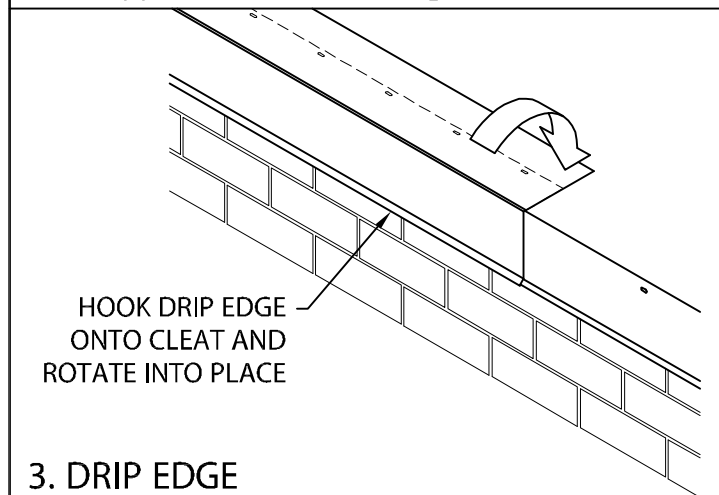

## 3. DRIP EDGE

HOOK DRIP EDGE OF EACH DRIP EDGE SECTION ONTO CONTINUOUS CLEAT, ROTATE INTO PLACE.

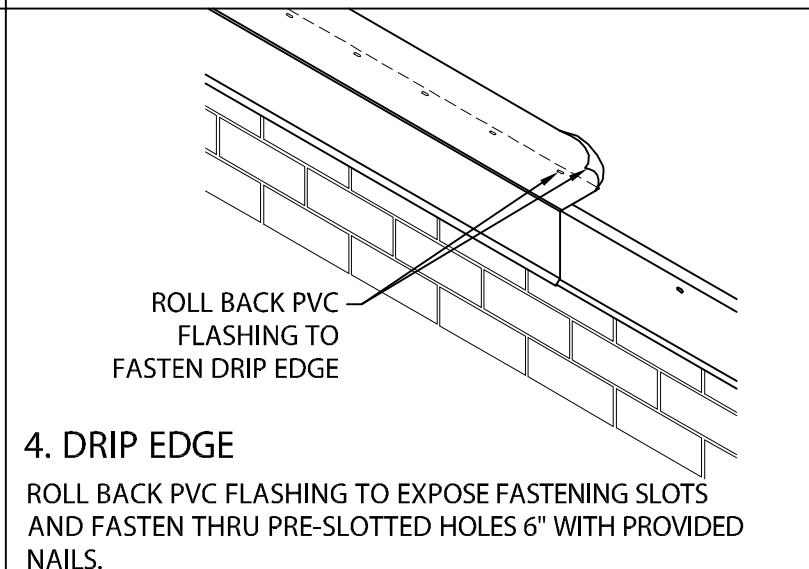

## 4. DRIP EDGE

ROLL BACK PVC FLASHING TO EXPOSE FASTENING SLOTS AND FASTEN THRU PRE-SLOTTED HOLES 6" WITH PROVIDED NAILS.

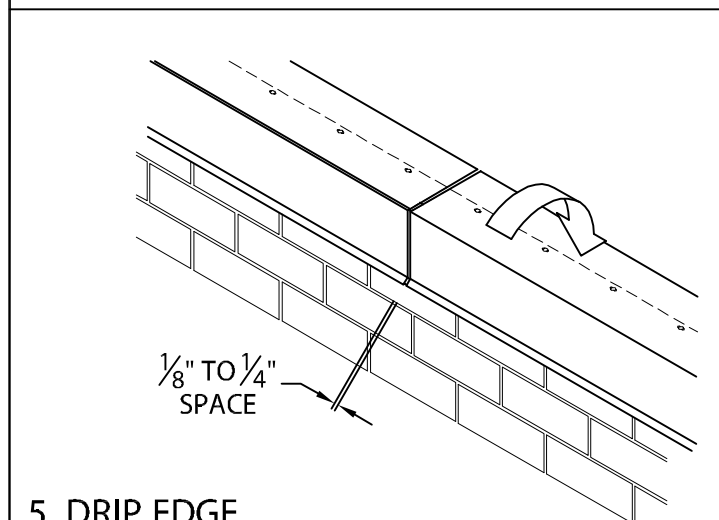

## 5. DRIP EDGE

CONTINUE INSTALLING 10'-0" LENGTHS OF DRIP EDGE. LEAVE A  $\frac{1}{8}$ " TO  $\frac{1}{4}$ " SPACE BETWEEN PIECES.

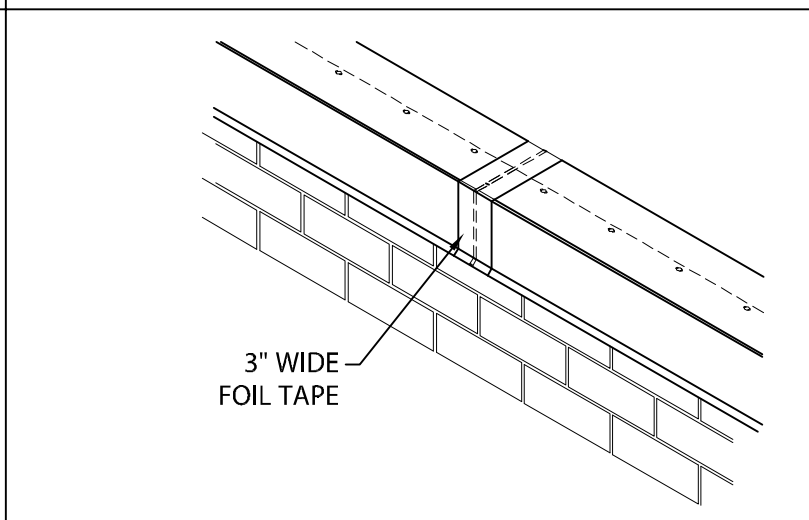

## 6. FOIL TAPE AT JOINT

PLACE A 3" WIDE PIECE OF FOIL TAPE OVER JOINT.



800-356-3521  
www.soprema.us

310 Quadral Dr.  
Wadsworth, OH 44281  
f: 330-334-6257

DATE: 01/09/17  
DRN BY: JJC  
CKD BY: SAK

SHT.# 1 OF 2  
DWG# 33110-25267

B

# SOPREMA SENTINEL DRIP EDGE

WITH FACTORY APPLIED PVC FLASHING AND CONTINUOUS CLEAT

NOTE: INSTALL MITERS FIRST

INSTALLATION INSTRUCTIONS

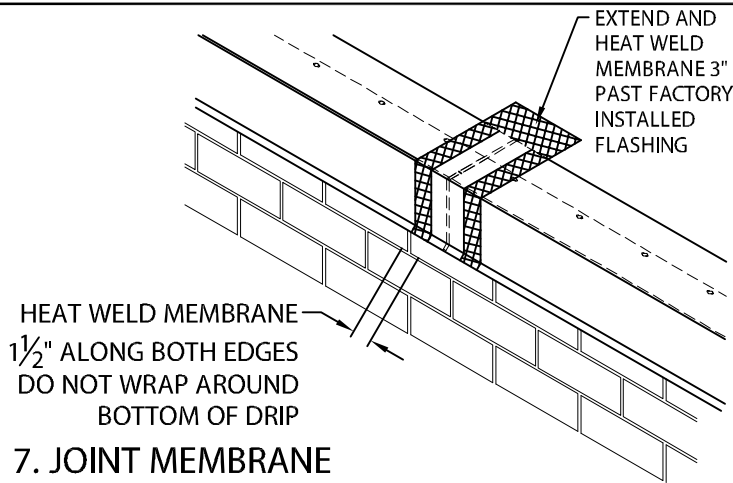

HEAT WELD MEMBRANE  
 $1\frac{1}{2}$ " ALONG BOTH EDGES  
DO NOT WRAP AROUND  
BOTTOM OF DRIP

## 7. JOINT MEMBRANE

HEAT WELD A 6" WIDE PIECE OF NON-REINFORCED  
MEMBRANE OVER JOINT AS SHOWN ABOVE.

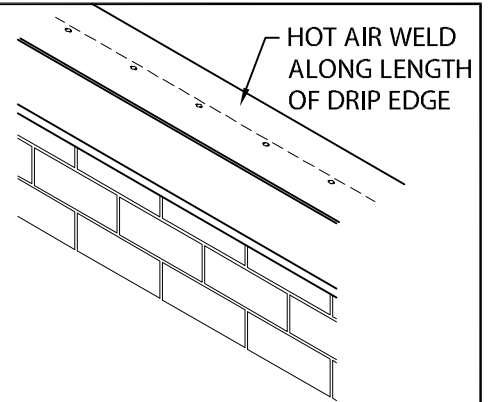

## 8. PVC FLASHING

HOT AIR WELD ALONG ENTIRE LENGTH OF DRIP  
EDGE PER SOPREMA'S INSTRUCTIONS.

## TYPICAL INSTALLATION

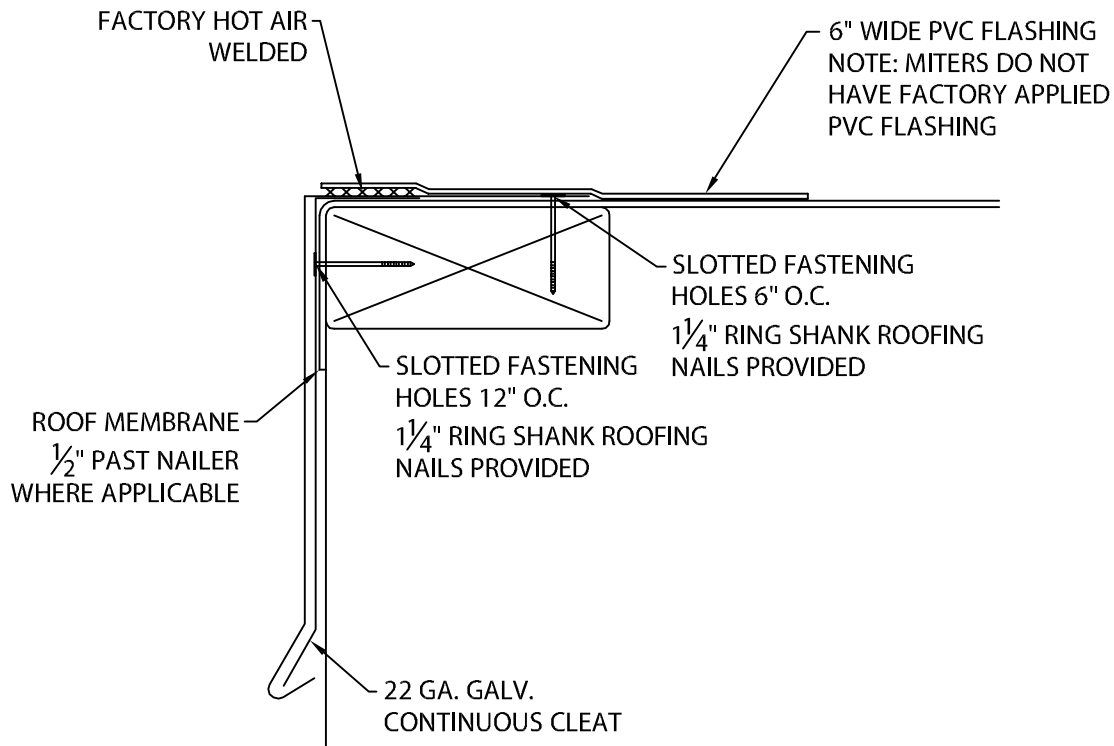

800-356-3521  
www.soprema.us

310 Quadral Dr.  
Wadsworth, OH 44281  
f: 330-334-6257

DATE: 01/09/17  
DRN BY: JJC  
CKD BY: SAK

SHT.# 2 OF 2

DWG# 33110-25267

B