

# OUTSIDE "T" COPING MITERS

FOR EXISTING SLOPE WALL CONDITIONS PLEASE CALL FOR CUSTOM PRINT

## RIGHT OUTSIDE "T" MITER

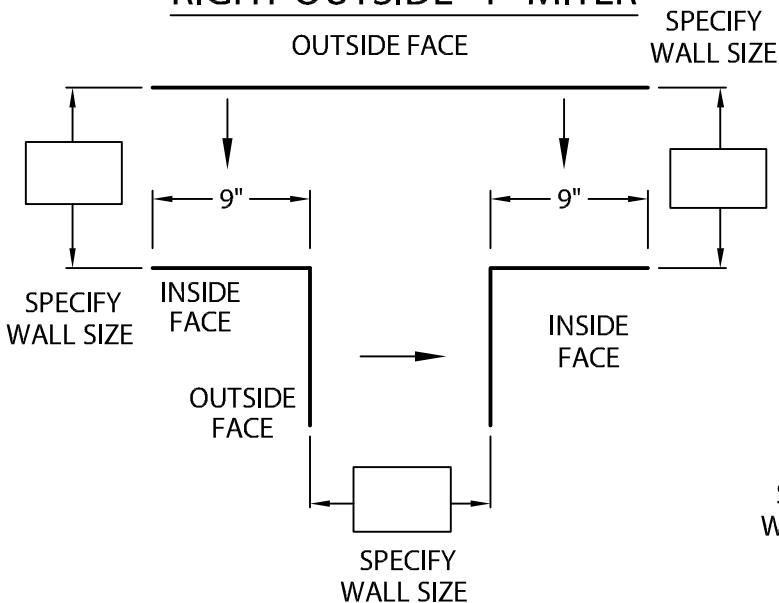

## LEFT OUTSIDE "T" MITER

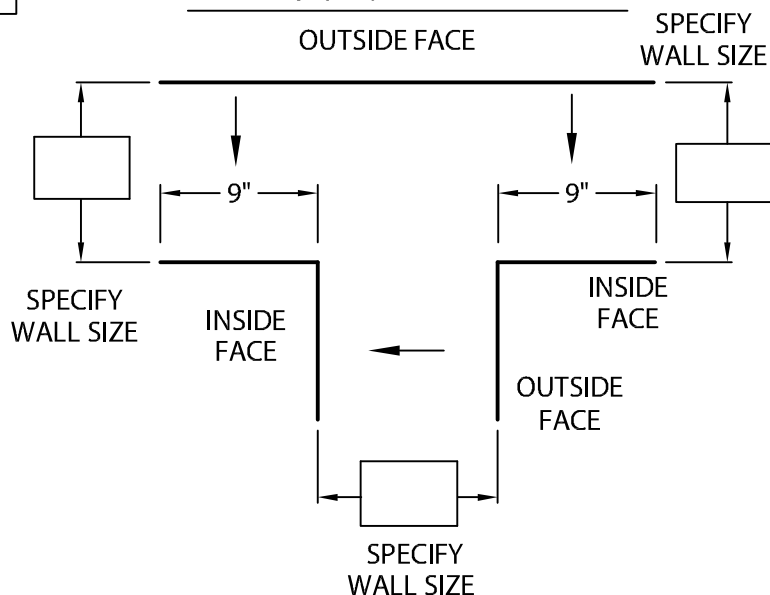

FOR CUSTOM LEG LENGTHS MODIFY DRAWINGS ABOVE

### NOTES:

- ① WELDED ACCESSORIES REQUIRE A MINIMUM MATERIAL THICKNESS OF .050".

### MATERIAL:

- \_\_\_ 24 GA. GALVANIZED STEEL
  - \_\_\_ 22 GA. GALVANIZED STEEL
  - \_\_\_ .040" ALUMINUM
  - \_\_\_ .050" ALUMINUM
  - \_\_\_ .063" ALUMINUM
  - \_\_\_ OTHER \_\_\_\_\_
- COLOR: \_\_\_\_\_
- FINISH: \_\_\_\_\_

### QUANTITIES:

- \_\_\_\_\_ RIGHT OUTSIDE "T" MITER
- \_\_\_\_\_ LEFT OUTSIDE "T" MITER

- SPECIFY ACCESSORY TYPE:
- WELDED ①
  - QUICKLOCK

AUTHORIZED SIGNATURE: \_\_\_\_\_

APPROVED BY: \_\_\_\_\_

DATE: \_\_\_\_\_

PROJECT: \_\_\_\_\_

ARCHITECT: \_\_\_\_\_

ROOFING CONTRACTOR: \_\_\_\_\_

REPRESENTATIVE/DISTRIBUTOR: \_\_\_\_\_

CUSTOMER SERVICE  
800-355-6416



DATE: 03/12/14  
DRN BY: JJC  
CKD BY: SAK

SHT.# \_\_\_\_ OF \_\_\_\_  
DWG# 23011-2483

B