

PMR LOCK FASCIA

LIGHTWEIGHT PROTECTED MEMBRANE ROOFING VERSION

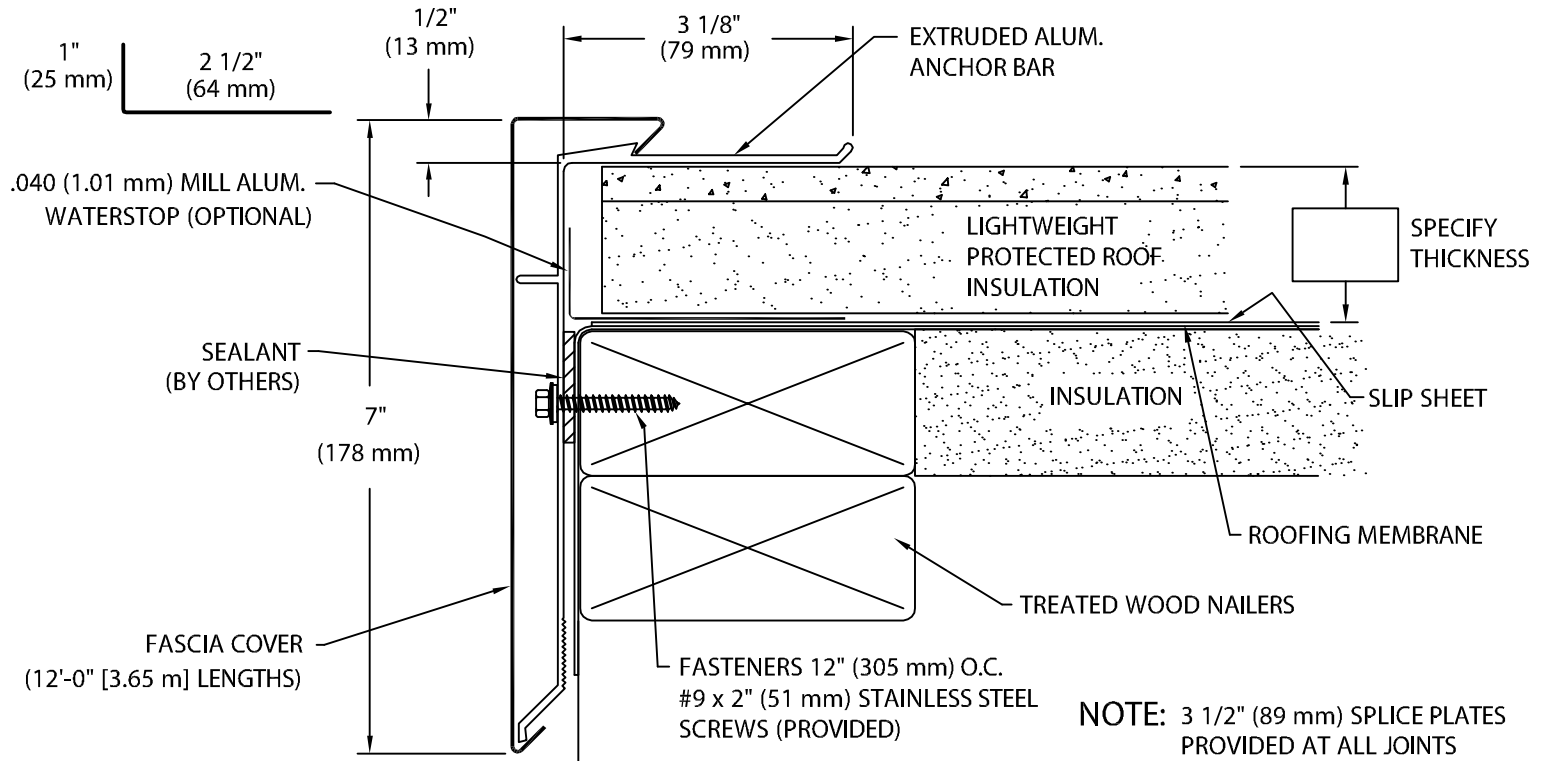

Fascia is to be installed per Specifications and Metal-Era's Installation Instructions Dwg. # 11110-1719

OPTIONAL: .040" (1.01 mm) MILL ALUMINUM WATERSTOP

* PLEASE
CHECK ONE *

SUPPLIED BY METAL-ERA

YES ☐ NO ☐

Fabrication will proceed only after receipt of signed print approval.

Print Approval:

Architect and/or contractor shall verify all dimensions, sizes and quantities. All products to be installed in strict accordance with Metal-Era's printed instructions.

Approved by: _____

Date: _____

MATERIAL:

____ 24 Ga. (.65 mm) Galv. Steel
____ .040" (1.01 mm) Aluminum
____ .050" (1.27 mm) Aluminum
____ .063" (1.60 mm) Aluminum
____ OTHER _____

Color: _____ Finish: _____

QUANTITIES:

____ Lineal Feet 12'-0" (3.65 m) Lengths

____ Outside Miters @ (____)°

____ Inside Miters @ (____)°

PROJECT:

ARCHITECT:

ROOFING CONTRACTOR:

REPRESENTATIVE/DISTRIBUTOR:

Corporate Offices, Manufacturing
1600 Airport Road; Waukesha, WI 53188
Phone: 800-558-2162
Fax: 800-373-9156
www.metalera.com



DATE: 12/18/12

DRN BY: JJC

CKD BY: SAK

SHT.# ____ OF ____

DWG# 11010-1610

H