

RADIUS COPING

MEASUREMENT INSTRUCTIONS

- Using the 36" straight edge provided, set it against the concave face of the parapet wall (as illustrated) typically 2-3 inches down from the top of the wall.
 - Using the 12" rule provided, measure the distance (rise) from the edge of the yardstick at the 18" mark straight in to the face of the parapet.
 - Repeat steps 1 and 2 in several more areas along the arch. Record these measurements in the boxes provided. We will calculate the radius from these measurements.
- NOTE!** If the measured rise dimensions vary by $\frac{1}{2}$ " or over, contact a Customer Service Rep. at 1-800-558-2162 for further instructions
- Fill in the general information below and fax this sheet back.

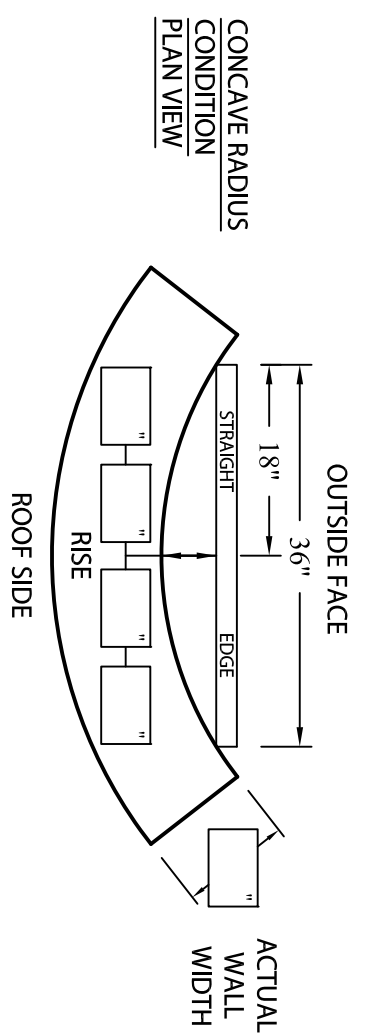
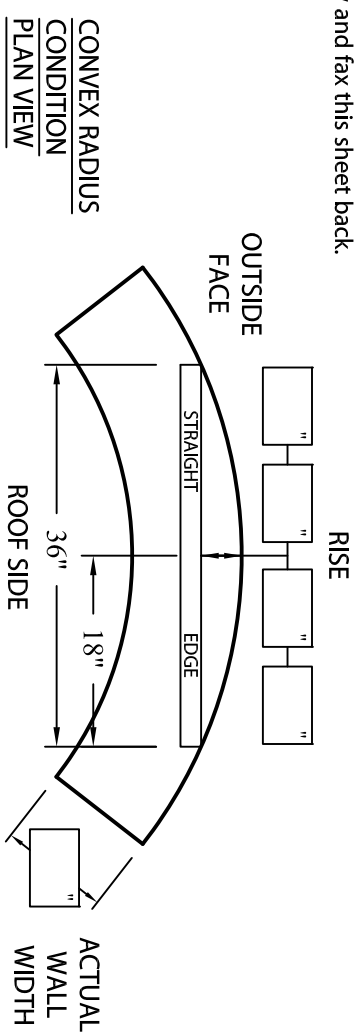

PROJECT INFORMATION:

(PROJECT NAME) _____ (ARCHITECT) _____ (ROOFING CONTRACTOR) _____ (REPRESENTATIVE/DISTRIBUTOR) _____



ELEVATE

ELEVATE
26 CENTURY BLVD.
SUITE 205
NASHVILLE, TN 37214
CONTACT YOUR LOCAL ELEVATE REPRESENTATIVE

DATE: 03/20/23	SHT.#	OF
DRN BY: MLM		
CKD BY: MM	DWG# 13511-4513	D