

## SUPERIOR STRENGTH WITH MAXIMUM WIND PROTECTION FOR YOUR ROOF

Anchor-Tite® Extended Fascia combines custom engineering and superior performance with an attractive appearance. The patented design of our extruded aluminum anchor bar securely terminates the membrane, providing protection superior to any other manufactured or shop-fabricated roof edge. The Extended Fascia is available in sizes from 8-1/2" to 13" face heights to accommodate multiple nailers and coverage requirements.

Rigorously tested, and backed by one of the industry's strongest wind warranty, it's proven to be compliant with all relevant building codes—providing the maximum protection against wind uplift damage that is available in today's roofing market.

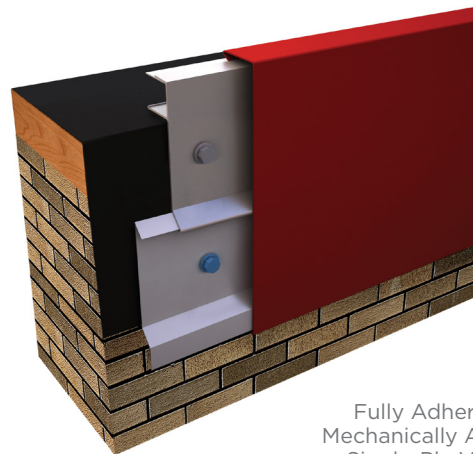

Fully Adhered or  
Mechanically Attached  
Single-Ply Version

### ANCHOR-TITE EXTENDED FASCIA AT-A-GLANCE

215 MPH Lifetime Wind Warranty

ANSI/SPRI/FM 4435/ES-1 Tested

FM Approved for Wind Uplift Protection

Miami-Dade County Approved

Variety of Colors, Sizes & Materials

Easy Install = Decreased Labor Costs



VERSIONS	STANDARD SIZES	COVER MATERIALS
<ul style="list-style-type: none"> <li>Fully Adhered or Mechanically Attached Single-Ply</li> <li>Built-up or Modified</li> </ul>	<ul style="list-style-type: none"> <li>8.5"</li> <li>10"</li> <li>11.5"</li> <li>13"</li> </ul>	<ul style="list-style-type: none"> <li>22 ga. Steel</li> <li>.050" Aluminum</li> <li>.063" Aluminum</li> </ul>

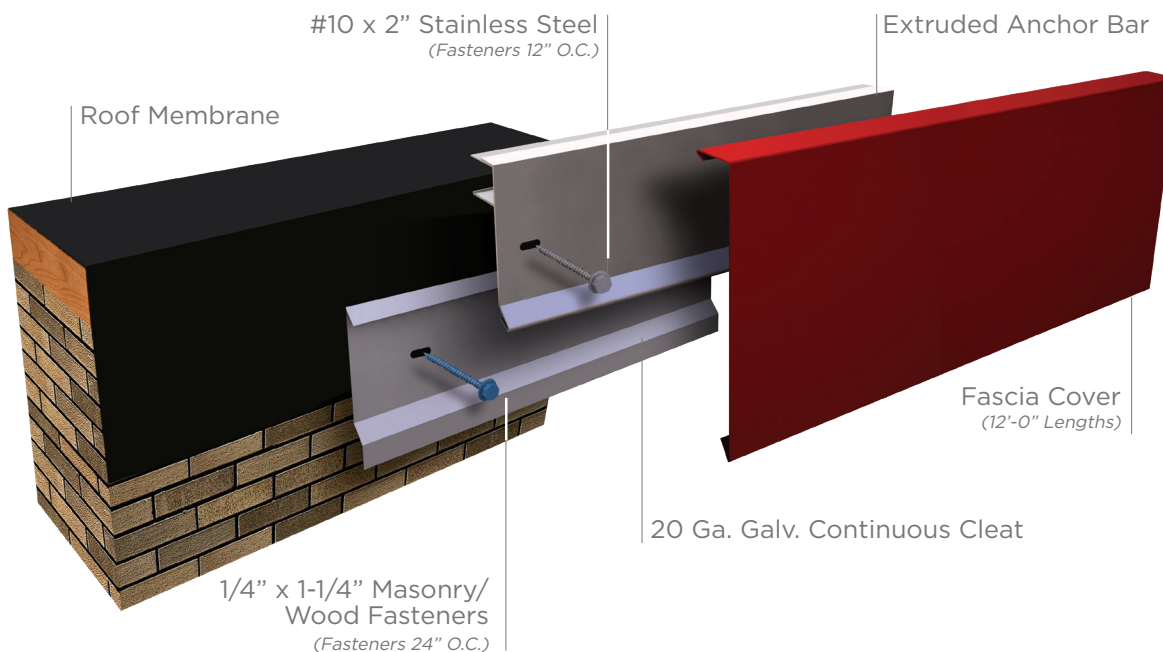

## 10 EXPRESS COLORS FOR QUICK SHIPPING

Express, standard, and premium colors and finishes are available to meet your job requirements and includes a 30-year Kynar 500® finish warranty on coil-coated standard colors. Custom colors are also available. For the most accurate color representation, contact us to request a paint chip.

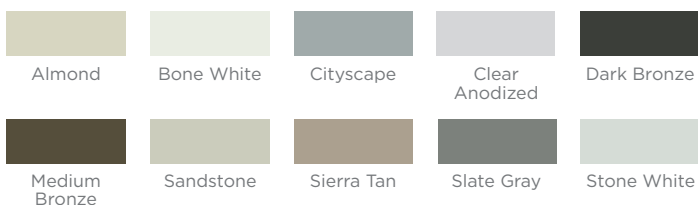

All colors are also available in Mill Finish.

## EASY INSTALLATION

**Typical Installation**  
Fully Adhered or Mechanically Attached Single-Ply Version

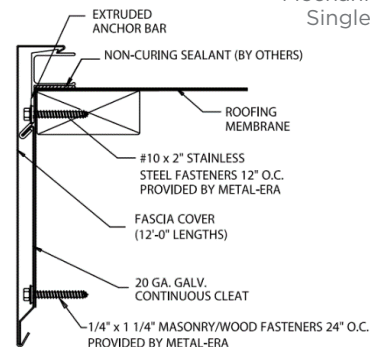

- Full snap-on design with extruded aluminum bar for easy installation
- No stripping-in or heat-welding typical with other systems for overall labor savings
- Prefabricated miters and accessories to prevent need for field fabrication
- Provided in 12' lengths with pre-punched holes for quicker installation