



APPROVED
1-405

SECUREDGE 1000 FASCIA SYSTEM

INSTALLATION INSTRUCTIONS FOR STANDARD AND STONE BALLAST SYSTEMS

NOTE: Position roof membrane on top of the wall covering the treated wood nailer(s) or substrate completely. Allow 1/2" minimum excess membrane beyond nailer where applicable. NRCA Requirement.

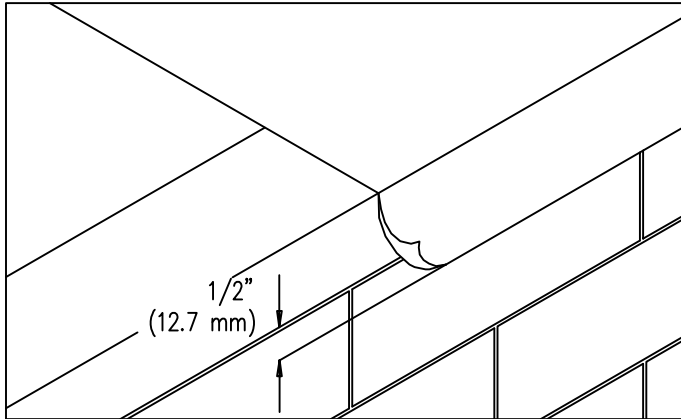

1. Roof Membrane

Position membrane over the roof edge and down outside face of wall, covering treated wood nailer(s) completely. Allow 1/2" (12.7 mm) excess membrane.

IMPORTANT! Outside edge of treated wood nailer(s) (minimum 2 x 4) shall be aligned flush with or extend slightly past outermost edge of wall.

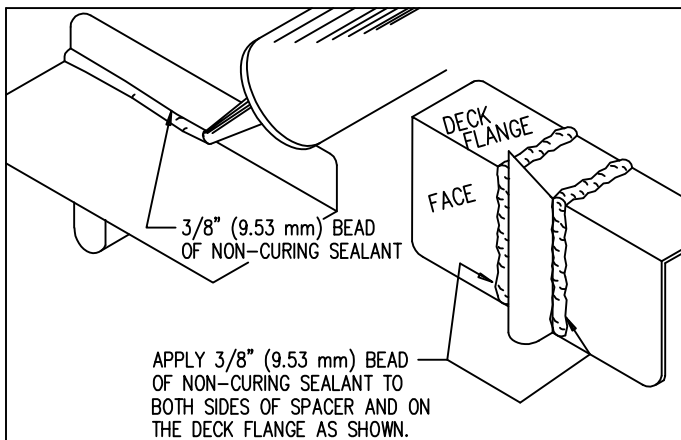

3. Retainer Guard Splice Plates

Apply Carlisle water cut-off mastic to each splice plate as shown and described in STEP 2.

CAUTION! Installers shall wear protective eyewear to prevent injury. Do not over-drive fasteners, as stripping can occur at high driver torque. Recommended driving tool : 600 – 800 rpm electric drill equipped with depth-sensing nosepiece to prevent over-driving and stripout. Do not use impact type tool.

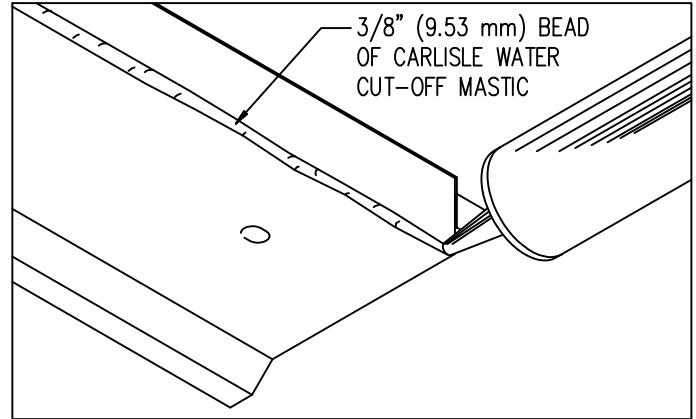

2. Miter & Scupper Retainer Guard (Preparation)

Lay miters and spillout scuppers on deck with outside face down. Be sure aluminum retainer guard is clean and free of dirt or dust. Apply a heavy 3/8" (9.53 mm) bead of Carlisle water cut-off mastic to the right angle intersection of the deck flange and back of retainer guard as shown. Application of mastic is required along the full length of each miter retainer guard.

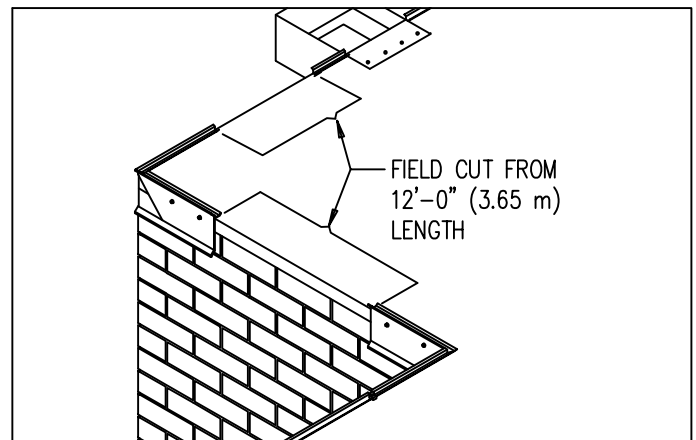

4. Miter Bar Installation

Fold roofing membrane at corners and install miters using the provided 2" (50.8 mm) stainless steel fasteners and driver bit furnished. Fasten retainer guard miters to nailer with one splice plate under each end of miters. The sponge gasket must be snug to ends of retainer guard. Next locate and install spillouts and scuppers with mastic, 2" fasteners and splice plates.



Customer Service
888-666-4369

DATE: 09/29/05
DRN BY: JJC
CKD BY: SAK

SHT.# 1 OF 2
DWG# 15110-1650

A



APPROVED
1-405

SECUREDGE 1000 FASCIA SYSTEM

INSTALLATION INSTRUCTIONS FOR STANDARD AND STONE BALLAST SYSTEMS

NOTE: Position roof membrane on top of the wall covering the treated wood nailer(s) or substrate completely. Allow 1/2" minimum excess membrane beyond nailer where applicable. NRCA Requirement.

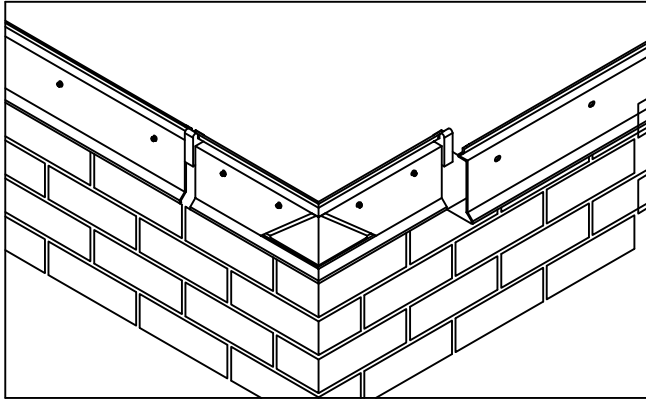

5. Retainer Guard (Installation)

Position 12'-0" (3.65 m) sections of retainer guard with applied mastic as shown in steps 2 & 3 overlapping splice plate and butting snugly into gasket. Allow 1/2" (12.7 mm) space between retainer guards. Install splice plate at other end of 12'-0" (3.65 m) guard. Fasten retainer guard 12" (304.8 mm) o.c. through slots using 2" (50.8 mm) stainless steel fasteners. Field cut sections as necessary.

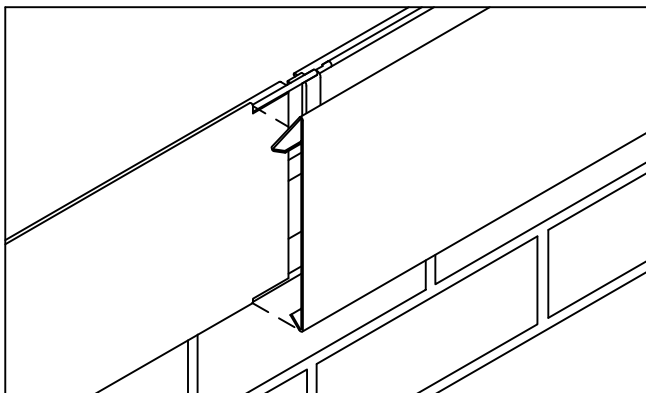

7. Fascia Panels

Position 12'-0" (3.65 m) fascia panels on top of retainer guard and overlap preceding panel approximately 1" (25.4 mm) at notches provided. Fascia covers shall be installed from right to left as seen from rooftop. With fascia panels in correct position atop retainer guard, simply snap each section onto retainer guard by applying downward pressure with palm of the hand until the fascia cover is fully engaged along the entire length. Continue to install fascia covers, field cutting where necessary using fine tooth hacksaw.

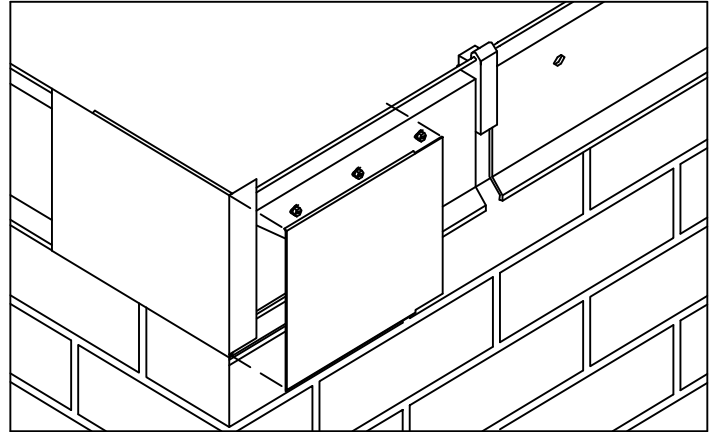

6. Fascia Miter Covers

Install 2-piece "snap-on" fascia miter covers first by snapping on fascia corner cover with 90° (degree) tab, followed by corner cover without the tab. Simply position the cover atop retainer guard with palm of hand apply slight pressure downward until engaged to retainer guard.

IMPORTANT! Be sure to remove protective plastic film prior to installing each fascia section.

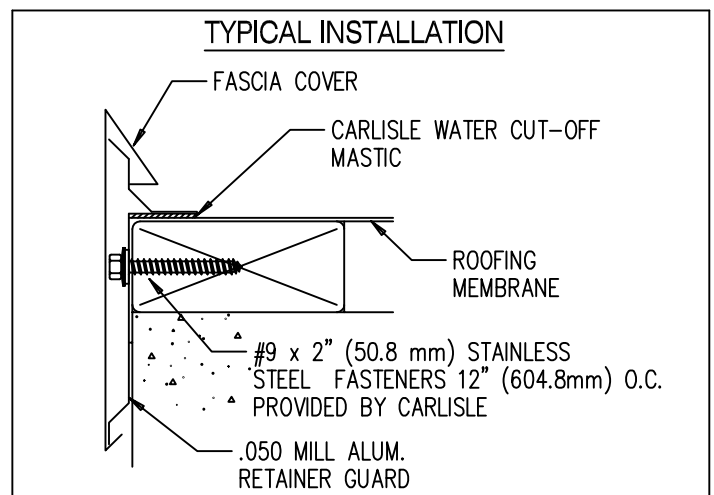

CARLISLE
Carlisle SynTec Incorporated

Customer Service
888-666-4369

DATE: 09/29/05

DRN BY: JJC

CKD BY: SAK

SHT.# 2 OF 2

DWG# 15110-1650

A