

STRAIGHT COPING TRANSITIONS

RIGHT TRANSITION

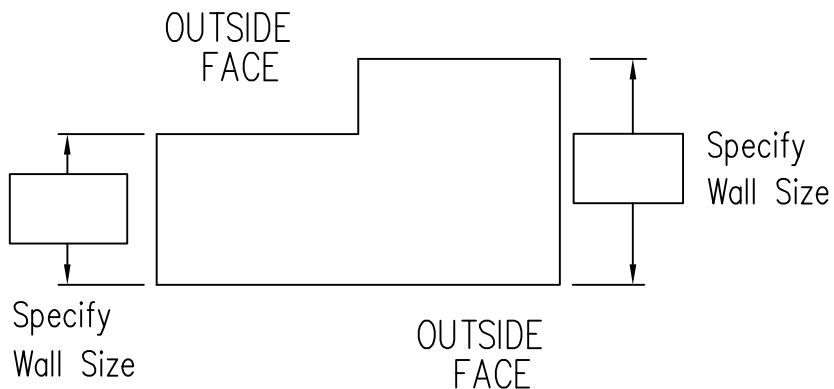

- Standard Leg Lengths
- Custom Leg Lengths _____

LEFT TRANSITION

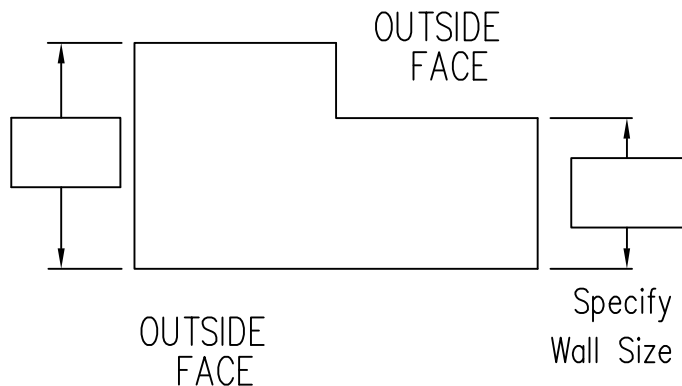

- Standard Leg Lengths
- Custom Leg Lengths _____

NOTE: Indicate slope by circling appropriate outside face.

NOTES: -- Concealed splice plates are provided with factory applied dual non-curing sealant strips.

-- Unless otherwise noted, fabrication of miters and accessories are furnished standard utilizing a non-penetrating "Quicklock" joint, then factory sealed watertight.

Fabrication will proceed only after receipt of signed print approval.

Print Approval:

Architect and/or contractor shall verify all dimensions, sizes, and quantities. All products to be installed in strict accordance with Carlisle SynTec, Inc. printed instructions.

Approved by: _____

Date: _____

-- Welded Miters and Accessories
Check one Required (surcharge) Not applicable

MATERIALS:

- ___ 24 GA. (.65 mm) Steel
- ___ .040" (1.01 mm) Alum. Color: _____
- ___ .050" (1.27 mm) Alum.
- ___ .063" (1.60 mm) Alum. Finish: _____
- ___ Other _____

QUANTITIES:

- ___ Right Transition
 - ___ Left Transition
- SECUREEDGE 200 COPING
- Tapered
 - Flat

PROJECT

ARCHITECT

ROOFING CONTRACTOR

REPRESENTATIVE/DISTRIBUTOR

Customer Service
888-666-4369
(Metal-Era)



DATE: 02/19/08

DRN BY: JJC

CKD BY: SAK

SHT.# ___ OF ___

DWG# 15011-1684

B