

# OUTSIDE "T" COPING MITERS

FOR EXISTING SLOPE WALL CONDITIONS PLEASE CALL FOR CUSTOM PRINT

## RIGHT OUTSIDE "T" MITER

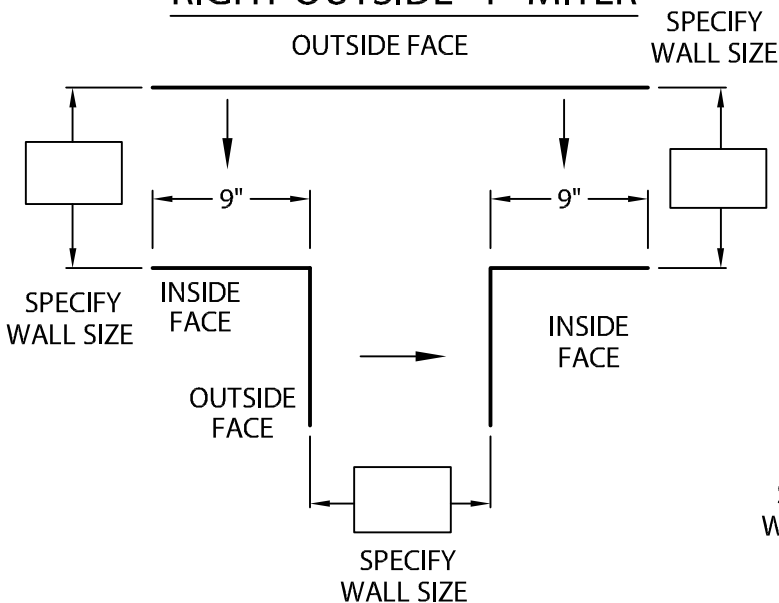

## LEFT OUTSIDE "T" MITER

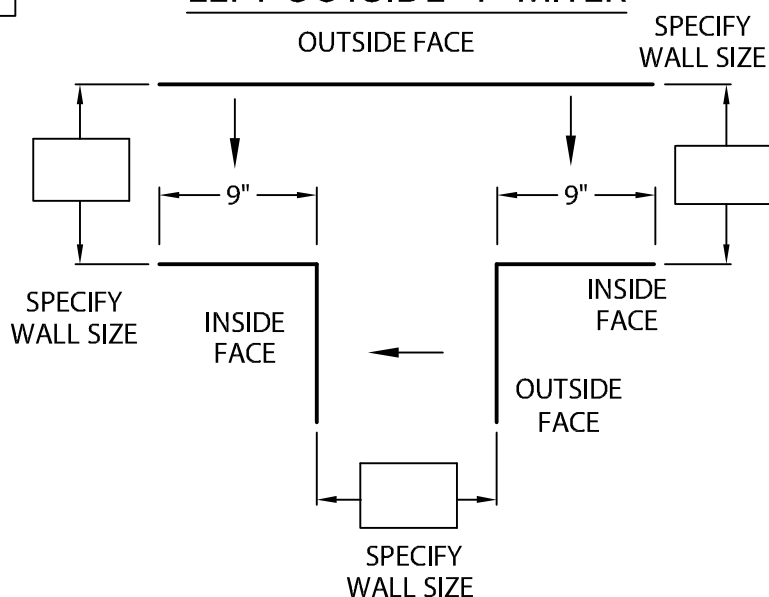

FOR CUSTOM LEG LENGTHS MODIFY DRAWINGS ABOVE

### NOTES:

- ① WELDED ACCESSORIES REQUIRE A MINIMUM MATERIAL THICKNESS OF .050".

### MATERIAL:

- \_\_\_ 24 GA. GALVANIZED STEEL
  - \_\_\_ 22 GA. GALVANIZED STEEL
  - \_\_\_ .040" ALUMINUM
  - \_\_\_ .050" ALUMINUM
  - \_\_\_ .063" ALUMINUM
  - \_\_\_ OTHER \_\_\_\_\_
- COLOR: \_\_\_\_\_
- FINISH: \_\_\_\_\_

### QUANTITIES:

- \_\_\_ RIGHT OUTSIDE "T" MITER
- \_\_\_ LEFT OUTSIDE "T" MITER

SPECIFY ACCESSORY TYPE:

- WELDED ①
- QUICKLOCK

AUTHORIZED SIGNATURE: \_\_\_\_\_

APPROVED BY: \_\_\_\_\_

DATE: \_\_\_\_\_

PROJECT: \_\_\_\_\_

ARCHITECT: \_\_\_\_\_

ROOFING CONTRACTOR: \_\_\_\_\_

REPRESENTATIVE/DISTRIBUTOR: \_\_\_\_\_

51 LEXINGTON STREET; LEWISTON, ME 04240  
 CUSTOMER SERVICE: 800-223-8317 USA  
 800-445-1500 CANADA  
 TECHNICAL SERVICE: 800-445-1500 USA & CANADA  
 FAX: 207-784-0125  
 OTHER AREAS CALL: 207-784-0123



DATE: 02/28/14

DRN BY: JJC

CKD BY: SAK

SHT.# \_\_\_\_ OF \_\_\_\_

DWG# 16011-2513

C