

# DOW SYSTEM 200 FASCIA

SNAP-ON VERSION

## INSTALLATION INSTRUCTIONS

### FOR RADIUS INSTALLATION INSTRUCTIONS SEE PAGE 6

GENERAL: THESE INSTRUCTIONS ARE THE BASIC ORDER IN WHICH THE DOW SYSTEM 200 IS INSTALLED WITH DOW MEMBRANE SYSTEMS. WITH SOME DOW SYSTEMS, THIS ORDER MUST BE CHANGED TO REFLECT DIFFERENT FLASHING REQUIREMENTS. REFER TO THE DOW DETAIL MANUAL FOR ADDITIONAL SPECIFICATIONS.

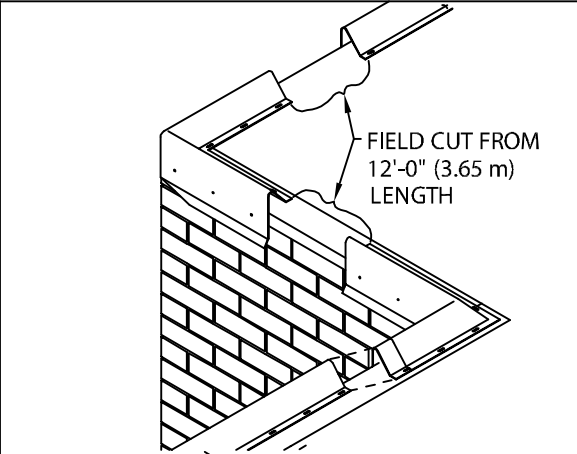
- 
1. LOCATE AND INSTALL MITERS, NAILING THROUGH PRE-SLOTTED FASTENING HOLES ON TOP FLANGE ONLY. DETERMINE AND IDENTIFY LOCATION OF SCUPPERS. DO NOT INSTALL SCUPPERS AT THIS TIME. LEAVE GAP OF 14 1/2" (368 mm) INCHES FOR SCUPPER LOCATIONS. THEN INSTALL THE 12'-0" (3.65 m) SECTIONS OF WATER DAM FROM RIGHT TO LEFT (AS SEEN FROM ROOF TOP) BY NAILING THROUGH SLOTTED HOLES PROVIDED PER JOB REQUIREMENTS. FIELD CUT SECTIONS AS NECESSARY. LAP WATER DAM JOINTS 1" (25 mm).

NOTE: DO NOT ATTACH FACE OF WATERDAM AT THIS TIME.

CAUTION: INSTALLERS SHALL WEAR PROTECTIVE EYEWEAR TO PREVENT SERIOUS INJURY.

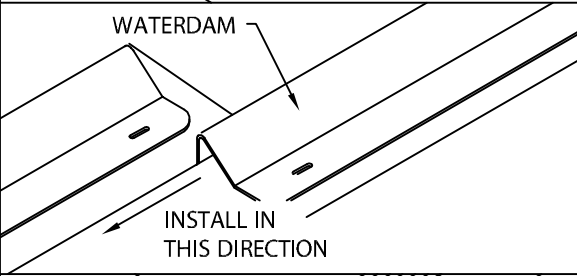
- 
2. POSITION DOW EP-B ROOF MEMBRANE OVER AND DOWN WATERDAM FACE APPROXIMATELY 1" (25 mm) BELOW EXTRUDED FASTENING HOLES TAKING CARE TO AVOID BRIDGING OF MEMBRANE. ATTACH MEMBRANE 12" (305 mm) O.C. THROUGH EXTRUDED HOLES ON OUTSIDE FACE USING 1 1/4" (32 mm) RING SHANK NAILS PROVIDED.

- 
3. INSTALL .055" (1.40 mm) UNSUPPORTED FLASHING AT ALL INSIDE AND OUTSIDE CORNERS.

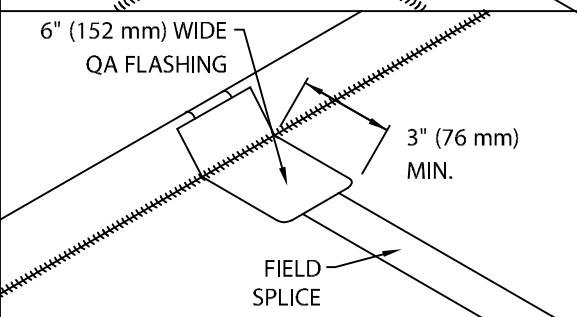
- 
4. INSTALL A 6" (152 mm) WIDE FLASHING STRIP OF DOW MEMBRANE OVER ALL FIELD SEAMS AS SHOWN. STRIP IS TO BE WELDED UP AND OVER THE WATERDAM. REFER TO DOWS' CURRENT SPECIFICATIONS FOR SPLICING PROCEDURES.



ROOFING SYSTEMS

P: 800-621-ROOF

DATE: 11/15/12

DRN BY: JJC

CKD BY: SAK

SHT.# 1 OF 7

DWG# 12110-11483

D

# DOW SYSTEM 200 FASCIA

SNAP-ON VERSION

## INSTALLATION INSTRUCTIONS

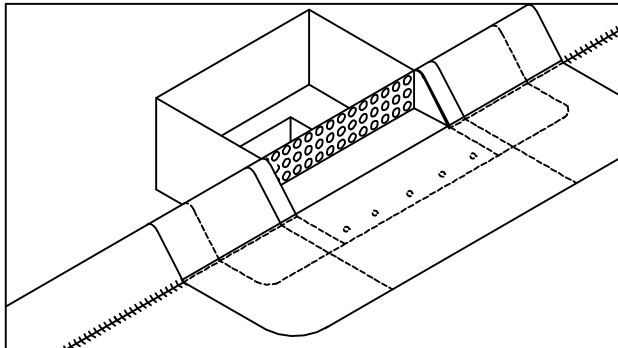

5. INSTALL SPILLOUT OR DOWNSPOUT SCUPPERS (IF APPLICABLE) AT PREDETERMINED LOCATIONS. (SEE PAGES 4 AND 5 FOR INSTALLATION INSTRUCTIONS).

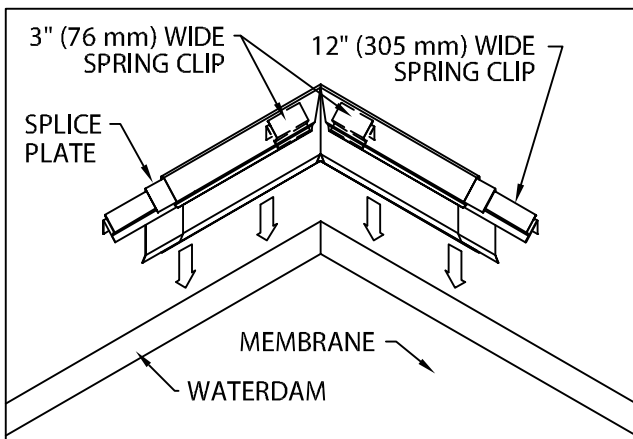

6. INSTALL MITER COVERS FIRST. INSERT ONE SPLICE PLATE AND ONE 12" (305 mm) WIDE SPRING CLIP INTO EACH END OF MITER COVER, HALF EXPOSED (SEE NEXT PAGE FOR PROPER SPRING INSTALLATION). PLACE TWO 3" (76 mm) WIDE SPRING CLIPS INTO CORNERS OF MITER AS SHOWN. INSTALL MITER COVERS BY PUSHING DOWNWARD UNTIL COVER IS ENGAGED ALONG ENTIRE MITER.

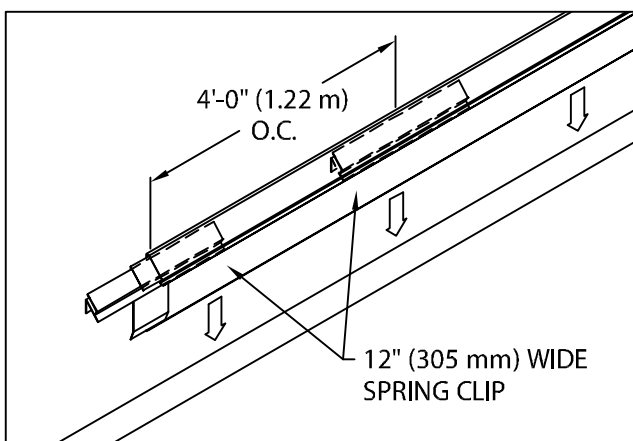

7. INSTALL 12'-0" (3.65 m) FASCIA COVER SECTIONS. INSERT ONE SPLICE PLATE AND ONE 12" (305 mm) WIDE SPRING CLIP UNDER FAR END OF FASCIA COVER, HALF EXPOSED. PLACE 12" (305 mm) WIDE SPRING CLIPS INTO COVER AT 4'-0" (1.22 m) O.C. INSTALL COVER BY PUSHING DOWNWARD UNTIL FASCIA COVER IS ENGAGED TO WATERDAM ALONG ENTIRE LENGTH. CONTINUE TO INSTALL FASCIA COVERS, LEAVING A 3/8" (10 mm) SPACE BETWEEN COVERS. FIELD CUT WHERE NECESSARY USING FINE TOOTH HACKSAW.

**CAUTION:** REMOVE PROTECTIVE FILM IMMEDIATELY AFTER INSTALLATION, WHERE APPLICABLE.



ROOFING SYSTEMS

P: 800-621-ROOF

DATE: 11/15/12

DRN BY: JJC

CKD BY: SAK

SHT.# 2 OF 7

DWG# 12110-11483

D

# DOW SYSTEM 200 FASCIA

SNAP-ON VERSION

## INSTALLATION INSTRUCTIONS

### SPRING DETAIL

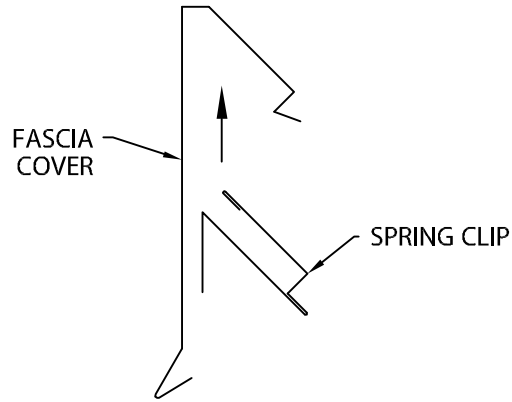

SIMPLY POSITION SPRING CLIP AS SHOWN AND PUSH STRAIGHT UP INTO COVER UNTIL SNAP LOCK OCCURS.

### TYPICAL INSTALLATION

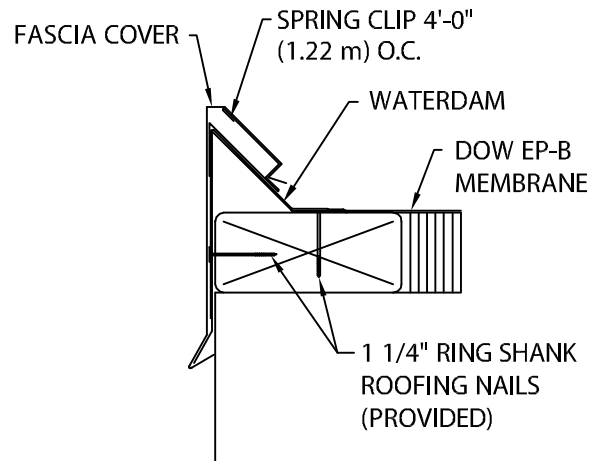

ROOFING SYSTEMS

P: 800-621-ROOF

DATE: 11/15/12

DRN BY: JJC

CKD BY: SAK

SHT.# 3 OF 7

DWG# 12110-11483

D

# DOW SYSTEM 200 FASCIA

SNAP-ON VERSION

## SCUPPER INSTALLATION INSTRUCTIONS

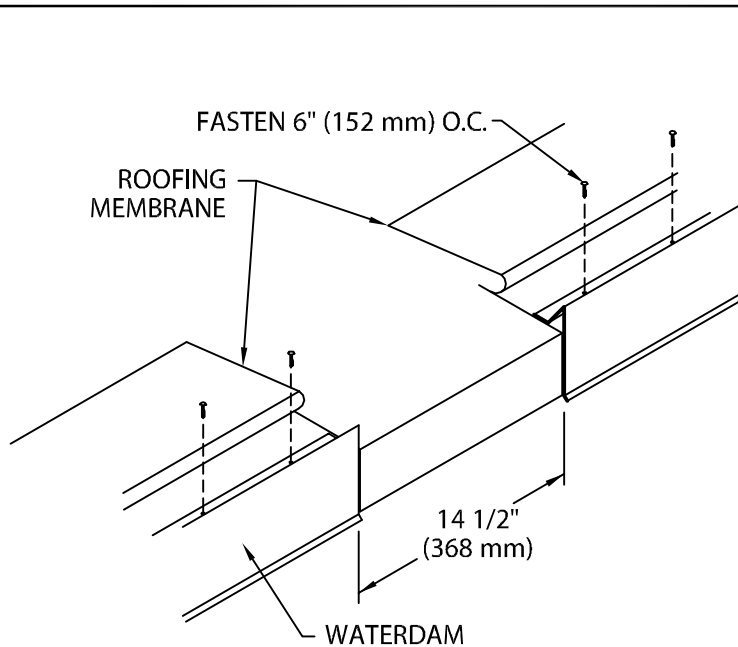

### STEP 1 - WATERDAM / ROOFING MEMBRANE

DETERMINE LOCATION OF SCUPPER AND SPACE WATERDAM 14 1/2" (368 mm) APART. CUT BACK MEMBRANE IN THIS AREA AS SHOWN. FASTEN WATERDAM FLANGE 6" (152 mm) O.C. WITH PROVIDED 1 1/4" (32 mm) RING SHANK ROOFING NAILS.

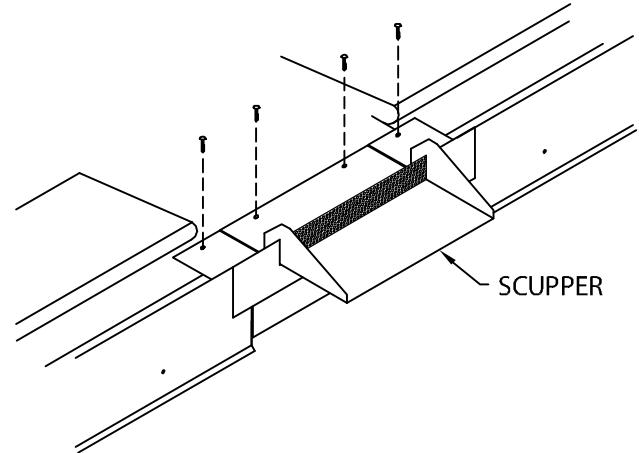

### STEP 2- SCUPPER

INSTALL SCUPPER WITH PROVIDED 1 1/4" (32 mm) RING SHANK ROOFING NAILS. ROOF MEMBRANE IS INSTALLED UNDER SCUPPER. SET SCUPPER FLANGE IN A CONTINUOUS BEAD OF DOW ALL-PURPOSE SEALANT.

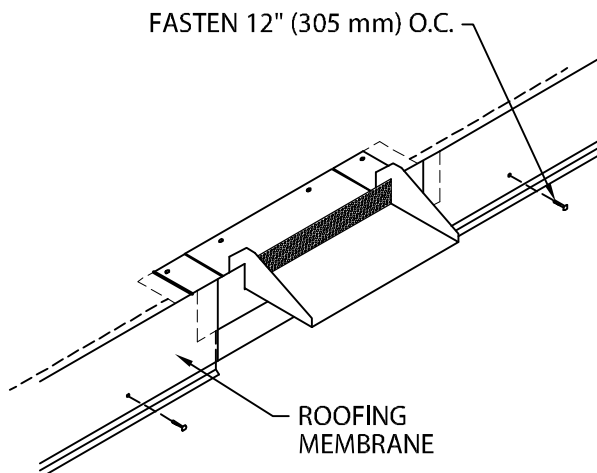

### STEP 3 - WATERDAM

POSITION ROOF MEMBRANE OVER AND DOWN WATERDAM FACE APPROXIMATELY 1" (25 mm) BELOW RAISED FASTENING HOLES. TAKE CARE TO AVOID BRIDGING OF MEMBRANE. LOCATE AND NAIL MEMBRANE AT 12" (305 mm) O.C. THROUGH ALL RAISED HOLES ON OUTSIDE FACE USING 1 1/4" (32 mm) RING SHANK ROOFING NAILS PROVIDED.

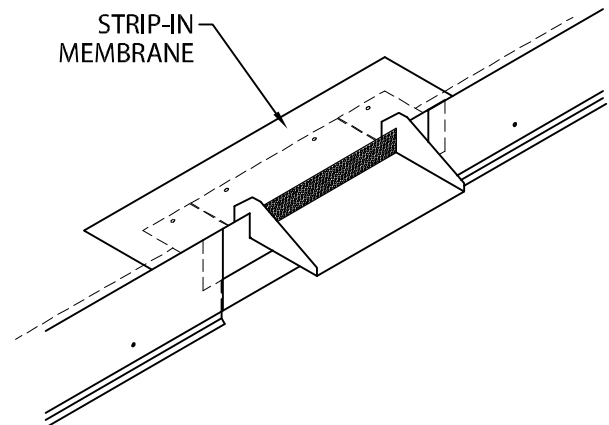

STEP 4 - STRIP-IN MEMBRANE  
STRIP-IN SCUPPER FLANGE.



ROOFING SYSTEMS

P: 800-621-ROOF

DATE: 11/15/12

DRN BY: JJC

CKD BY: SAK

SHT.# 4 OF 7

DWG# 12110-11483

D

# DOW SYSTEM 200 FASCIA

SNAP-ON VERSION

## SCUPPER INSTALLATION INSTRUCTIONS

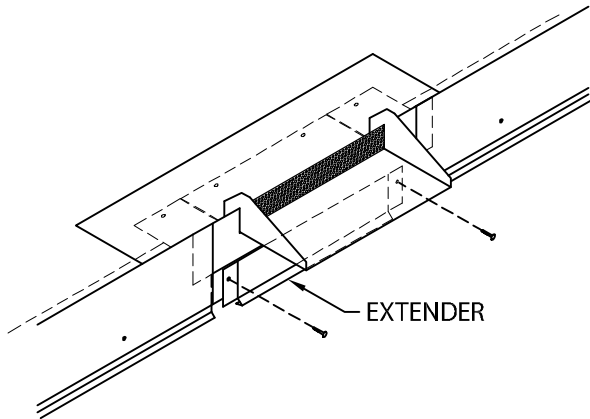

### STEP 5- EXTENDER

CENTER EXTENDER BELOW SCUPPER AND FASTEN THROUGH PRE-SLOTTED HOLES WITH PROVIDED NAILS AS SHOWN.

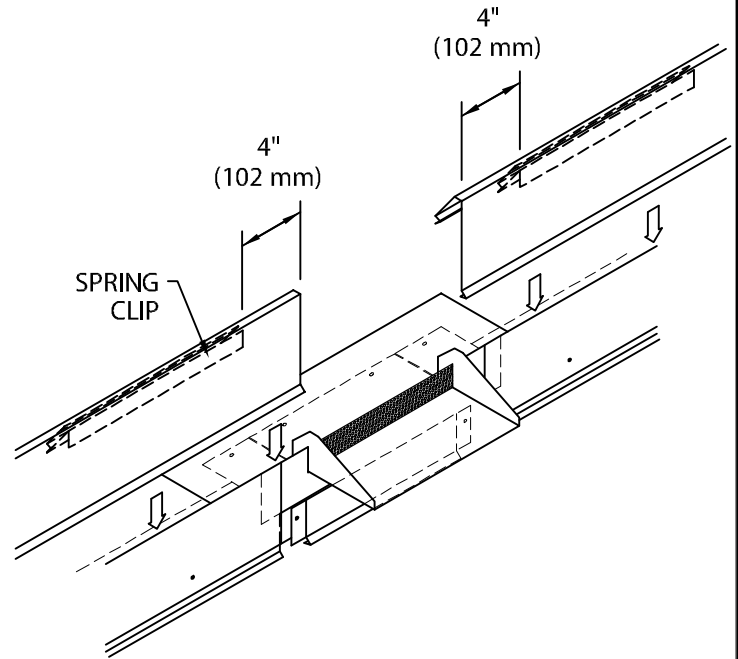

### STEP 6- SPRING CLIP / FASCIA COVER

PLACE SPRING CLIPS 4" (102 mm) FROM END OF FASCIA COVER. INSTALL COVER BY PUSHING DOWNWARD UNTIL FASCIA COVER IS ENGAGED TO WATERDAM. FASCIA COVER SHOULD FIT TIGHT AGAINST SIDES OF SCUPPER.



ROOFING SYSTEMS

P: 800-621-ROOF

DATE: 11/15/12

DRN BY: JJC

CKD BY: SAK

SHT.# 5 OF 7

DWG# 12110-11483

D

# DOW SYSTEM 200 FASCIA

SNAP-ON VERSION

## RADIUS INSTALLATION INSTRUCTIONS

### RADIUS INSTALLATION INSTRUCTIONS

1. FOLLOW DIRECTIONS ON PAGE 1 FOR INSTALLING WATERDAM AND ROOF MEMBRANE.

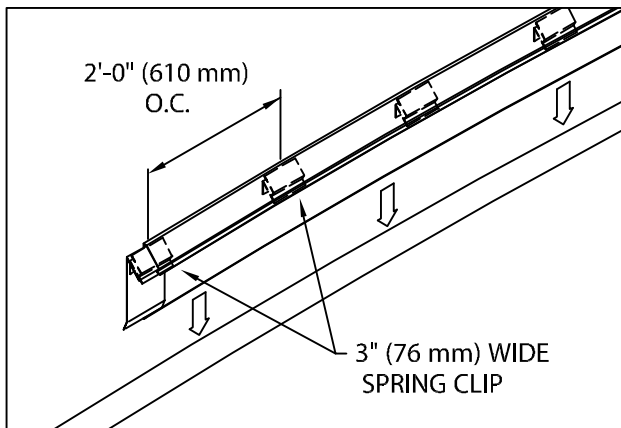

2. INSTALL 12'-0" (3.65 m) FASCIA COVER SECTIONS. INSERT ONE SPLICE PLATE AND ONE 3" (76 mm) WIDE SPRING CLIP UNDER FAR END OF FASCIA COVER, HALF EXPOSED. PLACE 3" (76 mm) WIDE SPRING CLIPS INTO COVER AT 2'-0" (610 m) O.C. INSTALL COVER BY PUSHING DOWNWARD UNTIL FASCIA COVER IS ENGAGED TO WATERDAM ALONG ENTIRE LENGTH. CONTINUE TO INSTALL FASCIA COVERS, LEAVING A 3/8" (10 mm) SPACE BETWEEN COVERS. FIELD CUT WHERE NECESSARY USING FINE TOOTH HACKSAW.

**CAUTION:** REMOVE PROTECTIVE FILM IMMEDIATELY AFTER INSTALLATION, WHERE APPLICABLE.

### SPRING DETAIL

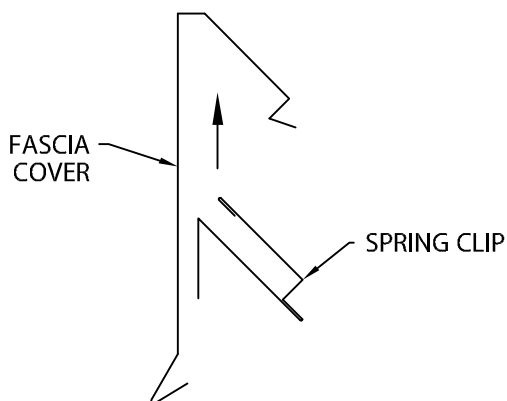

SIMPLY POSITION SPRING CLIP AS SHOWN AND PUSH STRAIGHT UP INTO COVER UNTIL SNAP LOCK OCCURS.

### TYPICAL RADIUS INSTALLATION

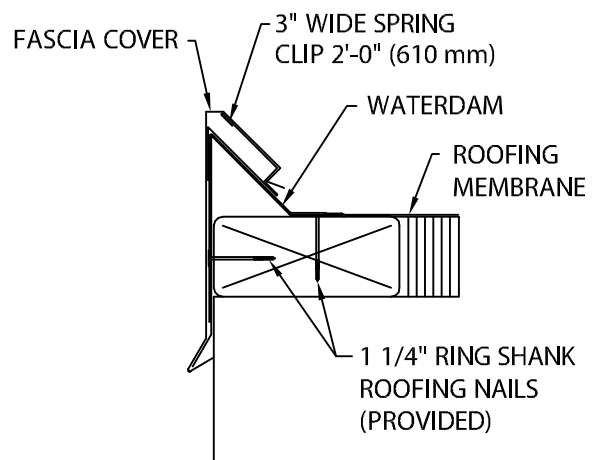

ROOFING SYSTEMS

P: 800-621-ROOF

DATE: 11/15/12

DRN BY: JJC

CKD BY: SAK

SHT.# 6 OF 7

DWG# 12110-11483

D

# DOW SYSTEM 200 FASCIA

SNAP-ON VERSION

## INSTALLATION INSTRUCTIONS

### COMPONENT LIST

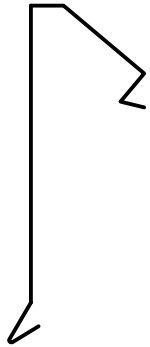

FASCIA COVER  
12'-0" (3.65 m) LENGTHS

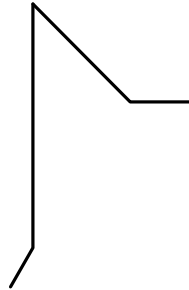

WATERDAM  
12'-0" (3.65 m) LENGTHS

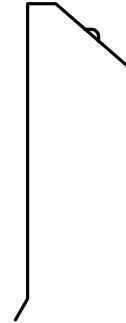

SPLICE PLATE  
3 1/2" (89 mm) WIDE

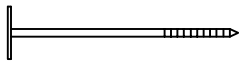

1 1/4" (32 mm) RING SHANK  
ROOFING NAIL

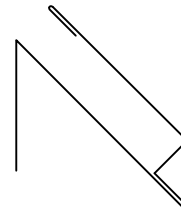

SPRING CLIP  
12" (305 mm) WIDE OR  
3" (76 mm) WIDE (RADIUS AND MITERS ONLY)

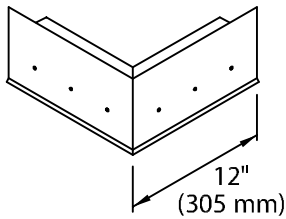

WATERDAM  
OUTSIDE MITER

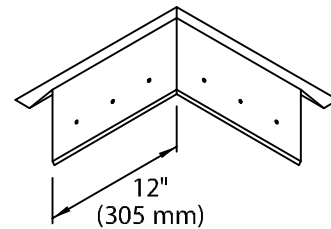

WATERDAM  
INSIDE MITER

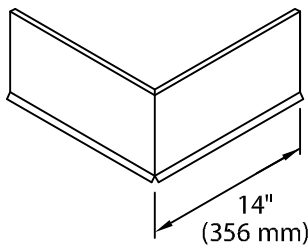

FASCIA COVER  
OUTSIDE MITER

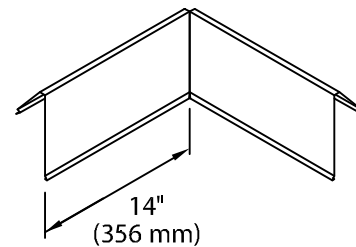

FASCIA COVER  
INSIDE MITER



ROOFING SYSTEMS

P: 800-621-ROOF

DATE: 11/15/12

DRN BY: JJC

CKD BY: SAK

SHT.# 7 OF 7

DWG# 12110-11483

D