

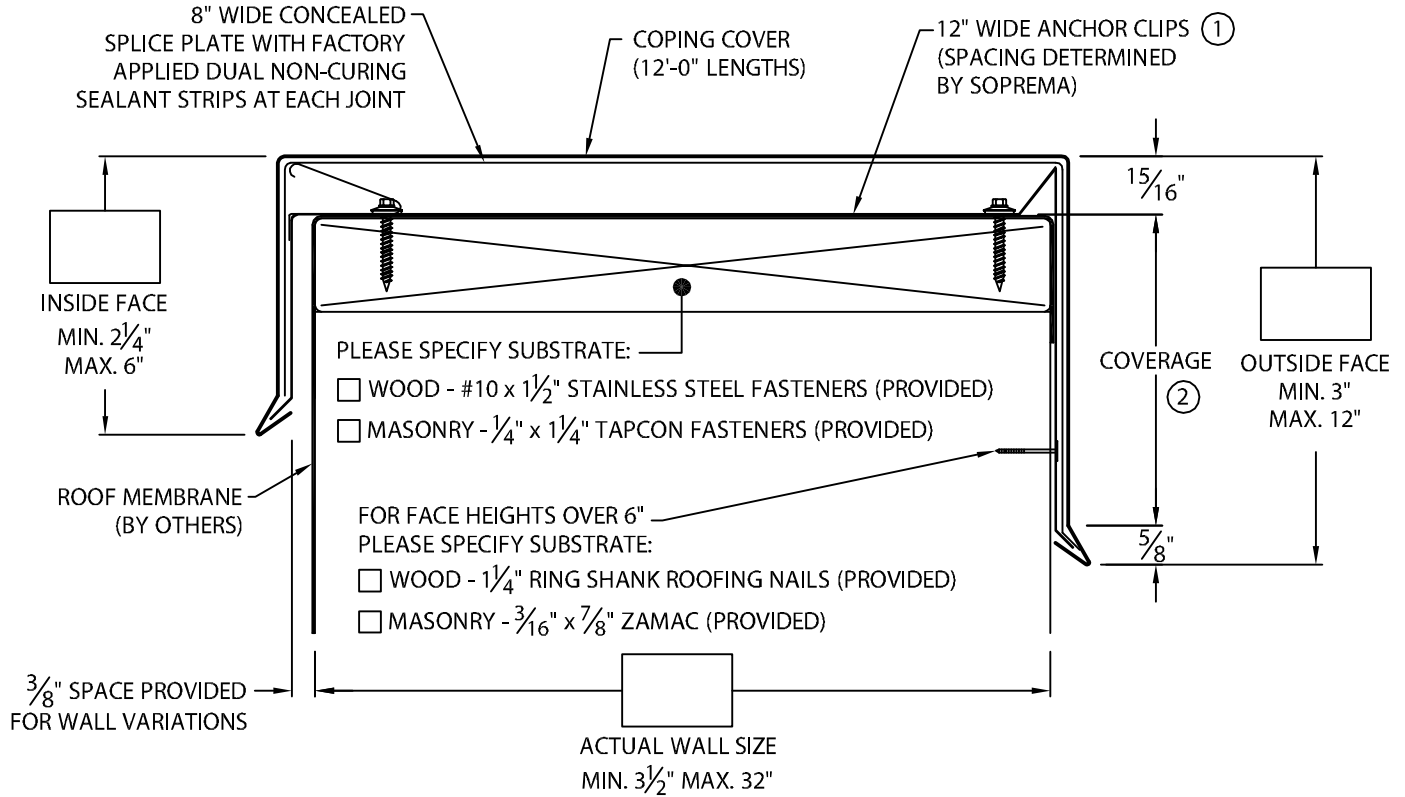

SOPREMA PERMA-TITE COPING

FLAT VERSION



NOTES:

- ① ANCHOR CLIP PROFILE ON WALLS GREATER THAN 14".
- ② FACE = COVERAGE (SHOULD EXTEND A MIN. OF 1" BELOW WATERPROOFING MEMBRANE) + 1 9/16".
- ③ 24 GA. GALV. AND .040" ALUM. COPING COVERS AVAILABLE FOR WALL SIZES 3 1/2" TO 24" ONLY.
- ④ WELDED ACCESSORIES REQUIRE A MINIMUM MATERIAL THICKNESS OF .050".
- ⑤ FOR NON 90° MITERS PLEASE USE PRINT APPROVAL #11011-1487.

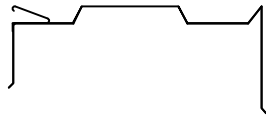

MATERIAL:

- ___ 24 GA. GALVANIZED STEEL ③
 - ___ 22 GA. GALVANIZED STEEL
 - ___ .040" ALUMINUM ③
 - ___ .050" ALUMINUM
 - ___ .063" ALUMINUM
 - ___ OTHER _____
- COLOR: _____
- FINISH: _____

QUANTITIES:

_____ LINEAL FEET 12'-0" LENGTHS

ACCESSORIES:

- SPECIFY ACCESSORY TYPE:
- ___ OUTSIDE MITERS @ 90° ⑤
 - ___ INSIDE MITERS @ 90° ⑤
 - ___ RIGHT ENDCAPS
 - ___ LEFT ENDCAPS
- WELDED ④
- QUICKLOCK

ENDWALL FLASHING (SPLICE PLATE VERSION)

RIGHT HAND _____ LEFT HAND _____

ENDWALL FLASHING (COPING VERSION)

RIGHT HAND _____ LEFT HAND _____

AUTHORIZED SIGNATURE:

APPROVED BY: _____

DATE: _____

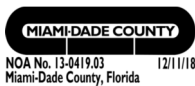

ANSI/SPRI ES-1 TESTED

PROJECT:

ARCHITECT:

ROOFING CONTRACTOR:

REPRESENTATIVE/DISTRIBUTOR:

800-356-3521
www.soprema.us

310 Quadral Dr.
Wadsworth, OH 44281
f: 330-334-6257

DATE: 10/05/15
DRN BY: JJC
CKD BY: SAK

SHT.# ___ OF ___

DWG# 33011-22875

A



SOPREMA PERMA-TITE COPING

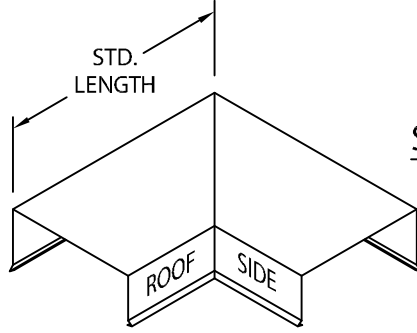

OUTSIDE MITER

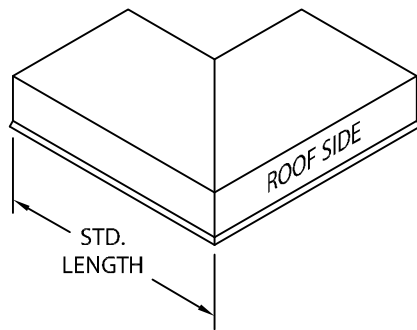

INSIDE MITER

MITER STANDARD LEG LENGTH:
 $WALL\ SIZE + 9\frac{5}{8}'' = LENGTH$

SOPREMA PERMA-TITE COPING STANDARD ACCESSORIES

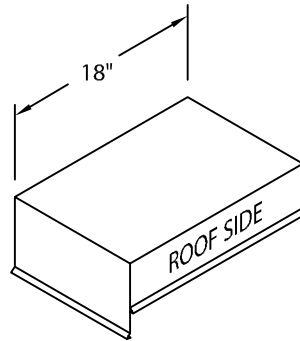

ENDCAP
 (LEFT HAND SHOWN)

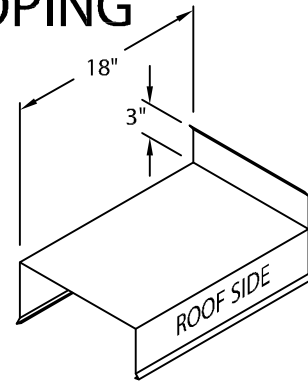

ENDWALL FLASHING
 COPING VERSION
 (RIGHT HAND SHOWN)

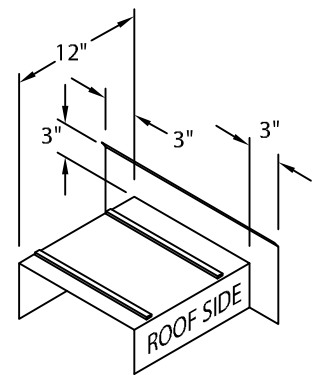

ENDWALL FLASHING
 SPLICE PLATE VERSION
 (RIGHT HAND SHOWN)
 (AVAILABLE ONLY IN
 .040\"/>

ADDITIONAL ACCESSORIES ARE AVAILABLE ON WEBSITE:

- TRANSITION MITERS
- STRAIGHT TRANSITION MITERS
- "T" MITERS
- "Z" MITERS
- STEP-UP MITERS
- PEAK / VALLEY MITERS
- PILASTER CAPS
- RADIUS COPING
- ARCHED COPING

(FOR ADDITIONAL ACCESSORY REQUIREMENTS, ATTACH SKETCHES OR CALL MANUFACTURER FOR ASSISTANCE).

ANCHOR CLIP SPACING:

- 24 GA. / .040", 16" WALL SIZE OR LESS, ANCHOR CLIPS ARE 48" O.C.
- 24 GA. / .040", OVER 16" WALL SIZE, ANCHOR CLIPS ARE 36" O.C.
- 22 GA. / .050" / .063", 26½" WALL SIZE OR LESS, ANCHOR CLIPS ARE 48" O.C.
- 22 GA. / .050" / .063", OVER 26½" WALL SIZE, ANCHOR CLIPS ARE 36" O.C.
- FLORIDA JOBS HAVE ANCHOR CLIPS 36" O.C. FOR ALL WALL SIZES.

ANCHOR CLIP MATERIAL IS 20 GA. GALV. FOR ALL WALL SIZES UP TO 26½".
 16 GA. GALV. FOR ALL WALL SIZES GREATER THAN 26½"

	800-356-3521 www.soprema.us	310 Quadral Dr. Wadsworth, OH 44281 f: 330-334-6257	DATE: 10/05/15	SHT.# ___ OF ___
			DRN BY: JJC	
			CKD BY: SAK	DWG# 33011-22875