

# ANCHOR-TITE FASCIA QUOTE/ORDER FORM

(circle one)

DATE: \_\_\_\_\_ SHIP TO: \_\_\_\_\_

P.O. #: \_\_\_\_\_

JOB NAME: \_\_\_\_\_

ORDERED BY: \_\_\_\_\_ CARRIER TO CALL 24 HRS. BEFORE DELIVERY: \_\_\_\_\_

COMPANY: \_\_\_\_\_

TELEPHONE: \_\_\_\_\_

FAX: \_\_\_\_\_ F.O.B. Destination

Check the appropriate fascia system and fill in dimensions

## ANCHOR-TITE FASCIA (STANDARD)

- AF-S40
- AF-S55
- AF-S70
- AF-S85

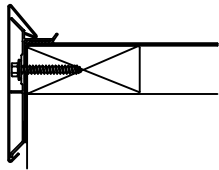

## ANCHOR-TITE FASCIA (BALLASTED)

- AFB-S50
- AFB-S65
- AFB-S80

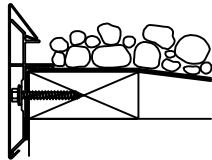

### Material: (Check one)

- 24 ga. (0.61 mm) Steel
- .040" (1.01 mm) Alum.

Color: \_\_\_\_\_ (Sm) (Tx)

Finish: \_\_\_\_\_

### QUANTITIES:

_____ L.F. (12' Lengths)	\$ _____ /LF
_____ EA. Outside Miters (90°)	\$ _____ /EA
_____ EA. Outside Miters (____°)	\$ _____ /EA
_____ EA. Inside Miters (90°)	\$ _____ /EA
_____ EA. Inside Miters (____°)	\$ _____ /EA
_____ EA. Overflow Scupper Style ___ A ___ B	\$ _____ /EA
_____ EA. Spillout Scupper Style ___ A ___ B	\$ _____ /EA
_____ EA. Downspout Scupper Style ___ A ___ B	\$ _____ /EA

A: Tapered 1 1/2" Drop  
B: Flat

## FASCIA EXTENDER

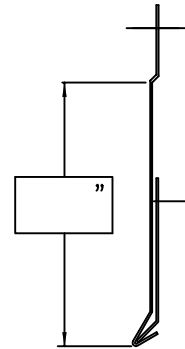

### Material: (Check one)

- 24 ga. (0.61 mm)
- .050" (1.27 mm) Alum.
- .040" (1.01 mm) Alum.
- .063" (1.60 mm) Alum.

Color: \_\_\_\_\_ (Sm) (Tx)

Finish: \_\_\_\_\_

### QUANTITIES:

_____ L.F. (12' Lengths)	\$ _____ /LF
_____ EA. Outside Miters (90°)	\$ _____ /EA
_____ EA. Outside Miters (____°)	\$ _____ /EA
_____ EA. Inside Miters (90°)	\$ _____ /EA
_____ EA. Inside Miters (____°)	\$ _____ /EA



Sika Sarnafil Inc.  
(800) 451-2504  
www.metalera.com/sikasarnafil

DATE: 05/29/02  
DRN BY: DJB  
CKD BY: SAK

SHT.# \_\_\_\_\_ OF \_\_\_\_\_  
DWG# 14810-2827 **C**