

# OUTSIDE "T" COPING MITERS

## RIGHT OUTSIDE "T" MITER

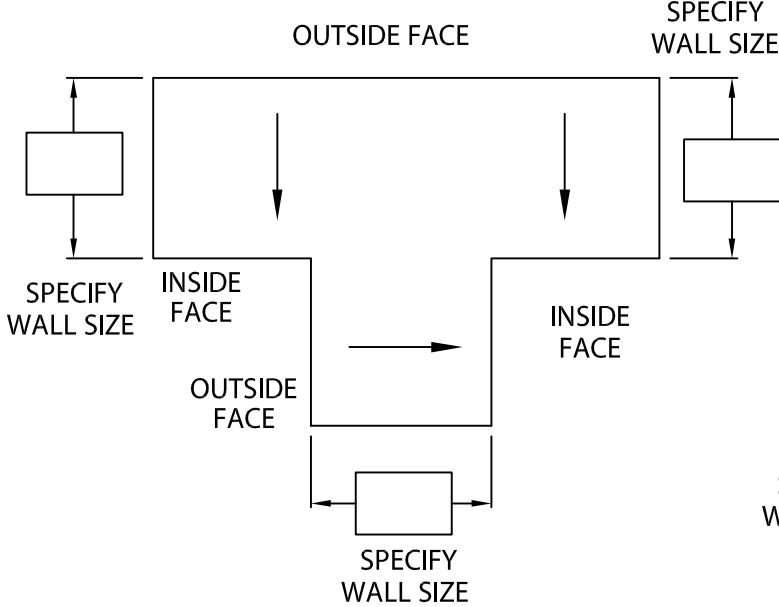

## LEFT OUTSIDE "T" MITER

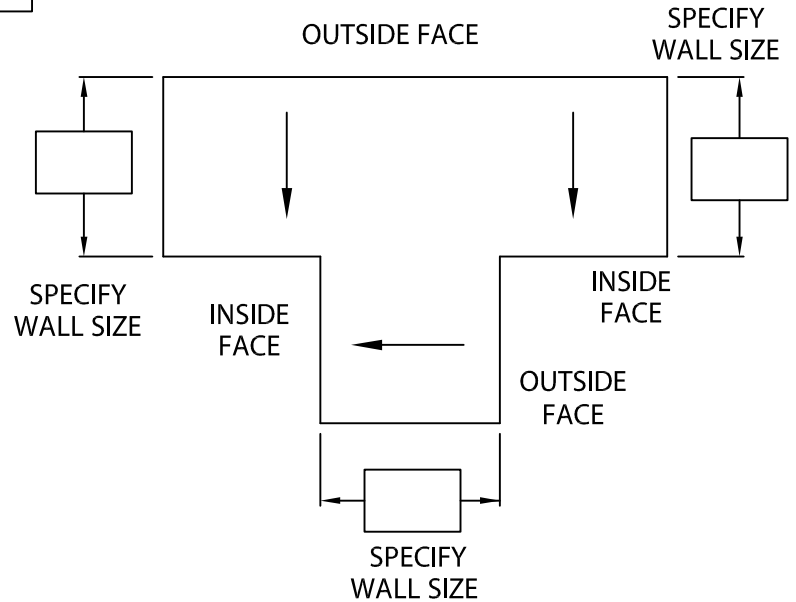

**NOTES:** -- Concealed splice plates are provided with factory applied dual non-curing sealant strips.

-- Unless otherwise noted, fabrication of miters and accessories are furnished standard utilizing a non-penetrating quicklock joint, then factory sealed watertight.

-- Welded Miters and Accessories

Check one  Required (surcharge)  Not applicable

### MATERIAL:

\_\_ 24 Ga. (.65 mm) Steel

\_\_ .040" (1.01 mm) Alum.

Color: \_\_\_\_\_

\_\_ .050" (1.27 mm) Alum.

\_\_ .063" (1.60 mm) Alum.

Finish: \_\_\_\_\_

\_\_ Other \_\_\_\_\_

### QUANTITIES:

\_\_\_\_\_ Right Outside "T"

\_\_\_\_\_ Left Outside "T"

Fabrication will proceed only after receipt of signed print approval.

## Print Approval:

Architect and/or contractor shall verify all dimensions, sizes and quantities. All products to be installed in strict accordance with Dow Roofing Systems' printed instructions.

Approved by: \_\_\_\_\_

Date: \_\_\_\_\_

PROJECT:

ARCHITECT:

ROOFING CONTRACTOR:

REPRESENTATIVE/DISTRIBUTOR:

Corporate Offices  
Dow Roofing Systems  
Nine Sullivan Road  
Holyoke, MA 01040  
P: 800-621-ROOF



**ROOFING SYSTEMS**

DATE: 02/03/09

DRN BY: JJC

CKD BY: SAK

SHT.# \_\_\_\_ OF \_\_\_\_

DWG# 12011-2996

**C**