

Anchor-Tite

Drip Edge

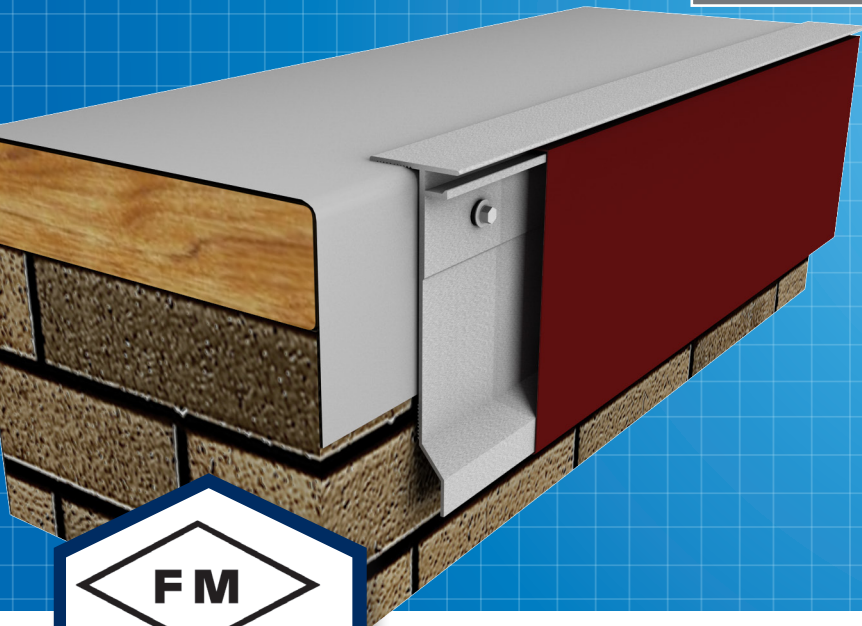

The Best of the Best

Anchor-Tite Drip Edge combines custom engineering and superior performance with an attractive appearance. The patented design of our extruded aluminum anchor bar securely terminates the membrane, providing protection superior to any other manufactured or shop-fabricated roof edge.

This top-line drip edge provides the maximum protection against wind uplift damage that is available in today's roofing market. It also comes with the industry's best warranty – a Lifetime, 215 mph Wind Warranty. Rigorously tested, Anchor-Tite Drip Edge is compliant with ANSI/SPRI/FM 4435/ES-1 and the International Building Code. All that and it is easy to install, reducing time and labor costs.



▶ **Eliminate stripping-in or heat welding of your TPO and PVC Drip Edges to protect your project, while keeping it ON TIME AND ON BUDGET.**

High Quality

- ▶ Backed by a Lifetime, 215 mph Wind Warranty
- ▶ Patented design for extreme durability
- ▶ Low profile allows water drainage for many conditions
- ▶ ANSI/SPRI/FM 4435/ES-1 tested to comply with the IBC
- ▶ 30 Year Kynar® paint finish
- ▶ Factory Mutual approved for wind uplift protection

Affordable

- ▶ Overall reduction in installed cost vs traditional systems
- ▶ Available in 30 color choices and 4.5" and 6" sizes

Easy Installation

- ▶ No need for stripping-in or heat welding that are typical with other systems
- ▶ Prefabricated miters and accessories ensure a proper fit and prevent the need for any field fabrication
- ▶ Full snap-on design facilitates easy installation
- ▶ Watertite integrity is not compromised by improper flashing procedures, failed adhesives, or lap sealants



With Metal-Era's SPEQ promise of speed, protection, expertise and quality, you are assured that Anchor-Tite is backed with quality and service guarantees.

800-558-2162
www.metalera.com

Quick Shipping in 11 Express Colors

15 standard and custom finishes are also available to meet your needs. Our finishes are made of Valspar's Fluropon® high performance Hylar 5000®/Kynar 500® finish and include a 30 year warranty. For the most accurate color representation, contact us to request a paint chip.

Call us at 800-558-2162 for lead times on your next project.

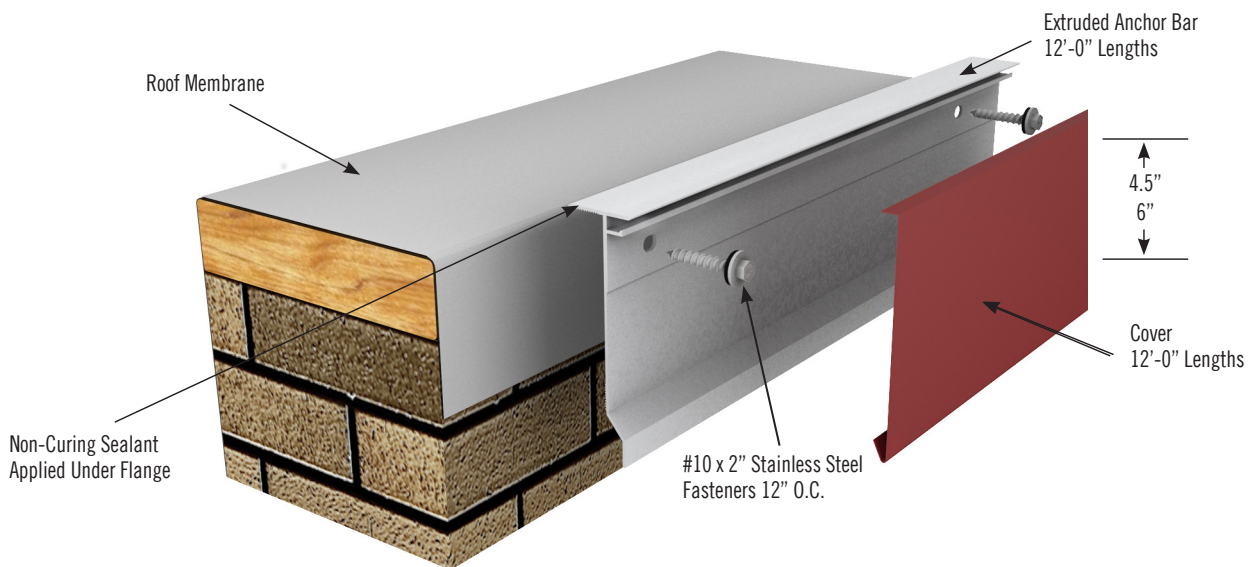
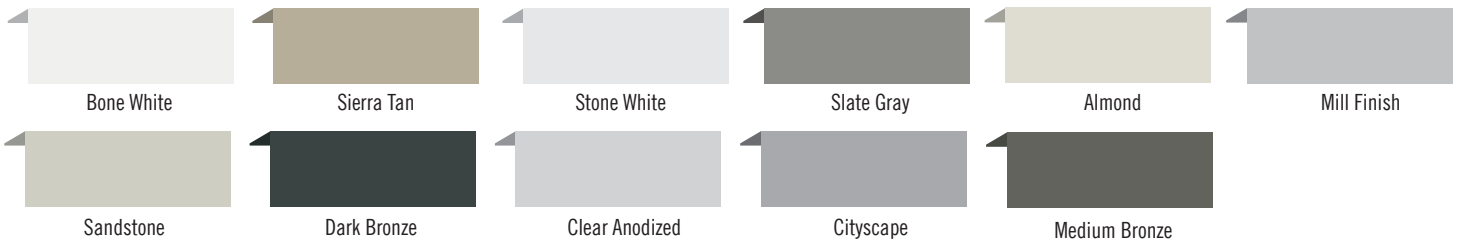

	Anchor-Tite Drip Edge	Typical Drip Edge
Price	<ul style="list-style-type: none"> Efficient, labor-saving design with no heat weld or strip-in needed 	<ul style="list-style-type: none"> Labor intensive with the need to heat weld or strip-in
Warranty	<ul style="list-style-type: none"> Lifetime, 215 mph wind warranty 30 year Kynar® finish warranty 5 year workmanship warranty 	<ul style="list-style-type: none"> Typically 1 or 2 year workmanship warranty
Other	<ul style="list-style-type: none"> Eliminates heat welding or strip-in edge failures ANSI/SPRI/FM 4435/ES-1 tested to comply with IBC Patented Design and pre-fabrication allows for extreme durability and consistency 	<ul style="list-style-type: none"> Common roof edge failures No testing Can vary from jobsite to jobsite



Metal-Era, Inc. is a Minority Business Enterprise and a member of the National Minority Supplier Development Council. Download the nationally accepted Minority Business certificate at www.metalera.com.

©2017. All statements herein are expressions of opinion, which by performance and testing are believed to be accurate and reliable, but are presented without guarantee or responsibility on our part. Statements concerning possible use of our products are made without any knowledge that such recommended uses may infringe any patent. No warranty, express or implied, other than that described in this literature, is made or intended. Kynar 5000® is a registered trademark belonging to Arkema Inc.

U.S. PATENT US 9,284,734 B1