

INSIDE "T" COPING MITERS

RIGHT INSIDE "T" MITER

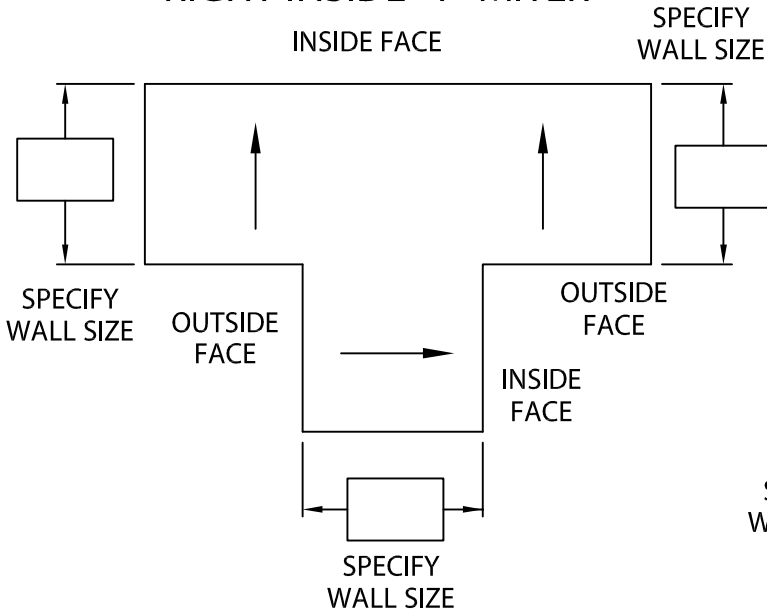

LEFT INSIDE "T" MITER

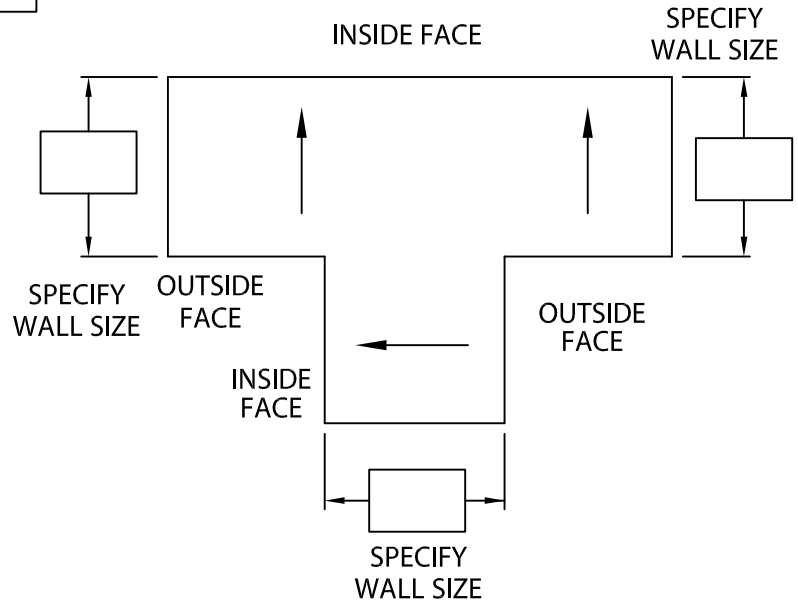

NOTES: -- Concealed splice plates are provided with factory applied dual non-curing sealant strips.

-- Unless otherwise noted, fabrication of miters and accessories are furnished standard utilizing a non-penetrating quicklock joint, then factory sealed watertight.

Fabrication will proceed only after receipt of signed print approval.

Print Approval:

Architect and/or contractor shall verify all dimensions, sizes and quantities. All products to be installed in strict accordance with Dow Roofing Systems' printed instructions.

Approved by: _____

Date: _____

-- Welded Miters and Accessories

Check one Required (surcharge) Not applicable

MATERIAL:

__ 24 Ga. (.65 mm) Steel

__ .040" (1.01 mm) Alum.

Color: _____

__ .050" (1.27 mm) Alum.

__ .063" (1.60 mm) Alum.

Finish: _____

__ Other _____

QUANTITIES:

_____ Right Inside "T" Miters

_____ Left Inside "T" Miters

PROJECT:

ARCHITECT:

ROOFING CONTRACTOR:

REPRESENTATIVE/DISTRIBUTOR:

Corporate Offices
Dow Roofing Systems
Nine Sullivan Road
Holyoke, MA 01040
P: 800-621-ROOF



ROOFING SYSTEMS

DATE: 02/03/09

DRN BY: JJC

CKD BY: SAK

SHT.# ___ OF ___

DWG# 12011-2995

C