

# HI-PERF RAKE FASCIA

WITH VERTICAL "Z" BRACKETS

INSTALLATION INSTRUCTIONS

## TYPICAL FASCIA INSTALLATION

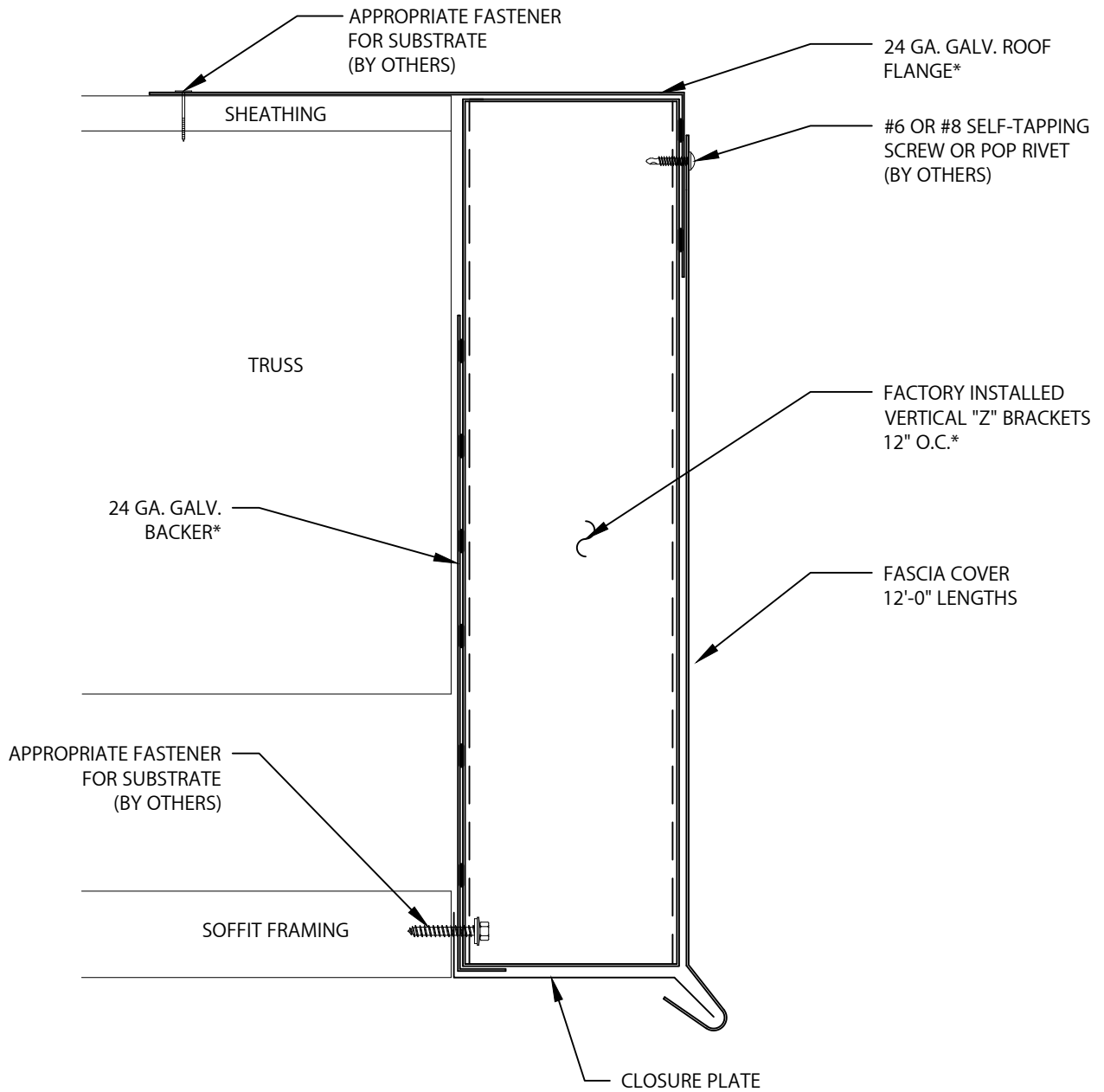

\*BACKER ASSEMBLY (FACTORY ASSEMBLED 24 GA. GALV. ROOF FLANGE, 24 GA. GALV. BACKER, CLOSURE PLATE AND VERTICAL "Z" BRACKETS 12" O.C.)



Phone: 800-558-2162  
 Fax: 800-770-3934  
 www.metalera.com

DATE: 09/09/22

SHT.# 1 OF 7

DRN BY: MLM

CKD BY: MM

DWG# 31127-7372

G

# HI-PERF RAKE FASCIA

WITH VERTICAL "Z" BRACKETS

INSTALLATION INSTRUCTIONS

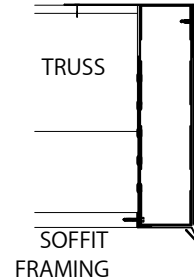
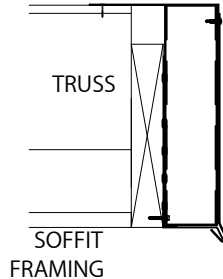
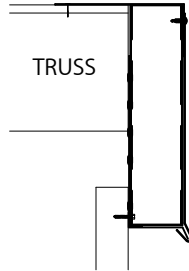

## 1. SUBSTRATE

SUBSTRATE MUST BE CONTINUOUS, FLAT, VERTICAL, AND ABLE TO SUPPORT FASTENERS WITH A MINIMUM 240 LB. PULL-OUT. EXAMPLES - ATTACHING FLUSH TO A WALL, TO A WOOD SUBSTRATE, TO SOFFIT FRAMING.

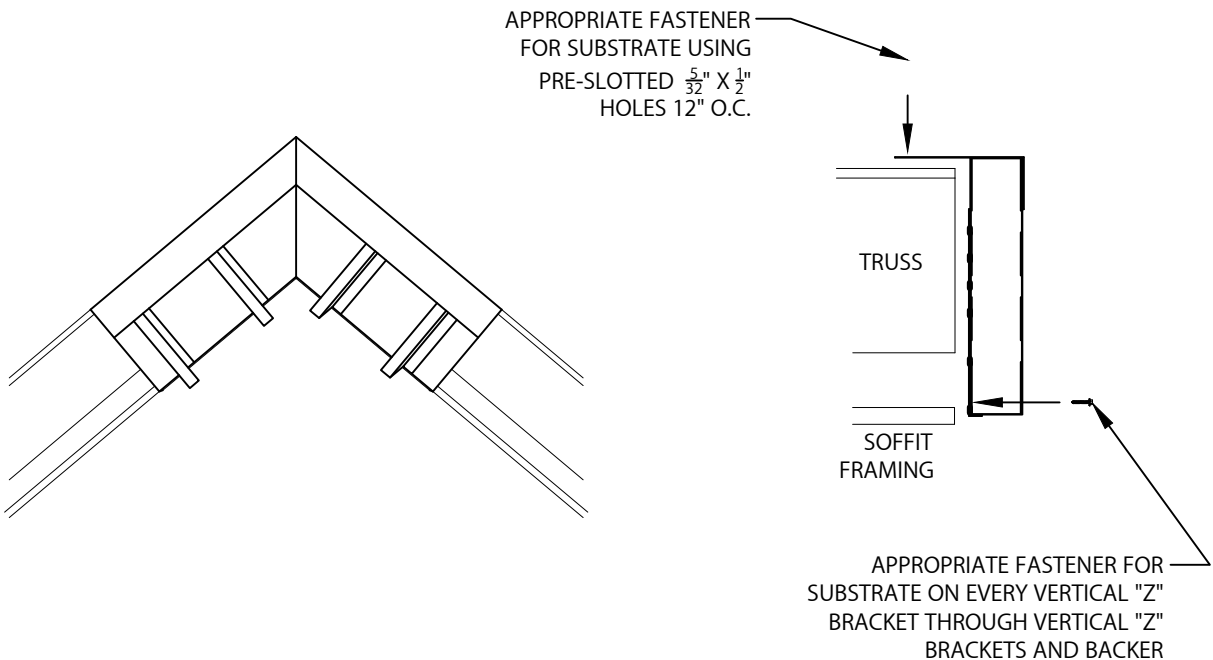

## 2. MITER BACKER ASSEMBLY ATTACHMENT - PEAK MITER SHOWN

ALIGN THE BACK OF THE BACKER ASSEMBLY WITH THE TRUSS. ALIGN THE TOP OF THE BACKER ASSEMBLY WITH THE TOP OF THE SHEATHING. ATTACH THE ROOF FLANGE OF THE BACKER ASSEMBLY TO THE TOP OF THE SHEATHING WITH AN APPROPRIATE FASTENER FOR THE SUBSTRATE USING THE PRE-SLOTTED  $\frac{5}{32}$ " X  $\frac{1}{2}$ " HOLES AT 12" O.C. ATTACH THE BACKER ASSEMBLY THROUGH THE VERTICAL "Z" BRACKETS AND BACKER USING APPROPRIATE FASTENER FOR SUBSTRATE ON EVERY VERTICAL "Z" BRACKET.

NOTE: BE SURE TO CHECK AND MAKE SURE THE MITERS ARE PLUMB, LEVEL, AND CENTERED AT THE CORNER. IT MAY BE HELPFUL TO ATTACH THE MITER TO A STRAIGHT PIECE OF THE BACKER ASSEMBLY TO AID IN THE ALIGNMENT PROCESS.

REFERENCE THE EAVE INSTALLATION INSTRUCTIONS FOR THE EAVE TO RAKE MITER BACKER ASSEMBLY ATTACHMENT



Phone: 800-558-2162  
Fax: 800-770-3934  
www.metalera.com

DATE: 09/09/22

SHT.# 2 OF 7

DRN BY: MLM

CKD BY: MM

DWG# 31127-7372

G

# HI-PERF RAKE FASCIA

WITH VERTICAL "Z" BRACKETS

INSTALLATION INSTRUCTIONS

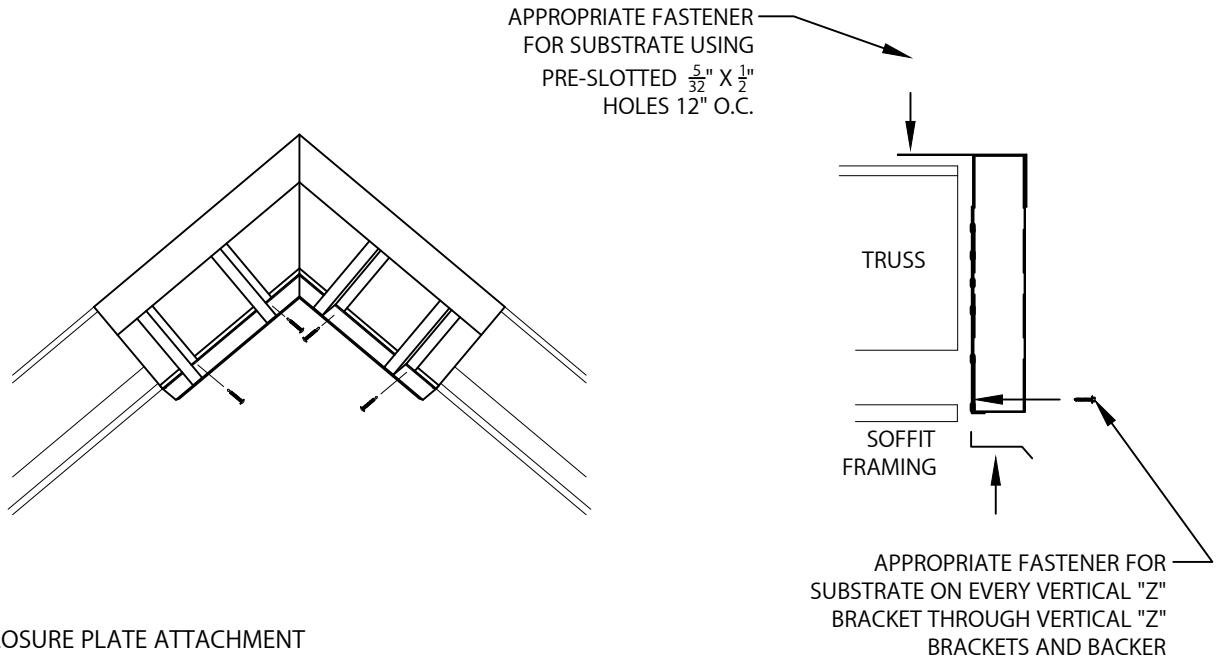

### 3. MITER CLOSURE PLATE ATTACHMENT

STARTING AT THE CORNER, ALIGN A TRIMMED PIECE OF PERFORATED CLOSURE WITH THE BOTTOM OF THE BACKER ASSEMBLY. NOTE: THE 1½" VERTICAL TAB OF THE PERFORATED CLOSURE SHOULD BE NOTCHED TO FIT BEHIND THE 24 GA. GALV. BACKER. PLACE FASTENER IN EACH FLANGE OF THE INTERMITTENT SPACER WHICH WILL GO THROUGH THE "Z" BRACKET AND 1½" TAB OF THE PERFORATED CLOSURE.

NOTE: MITER OF THE CLOSURE PLATE IS DONE IN THE FIELD.

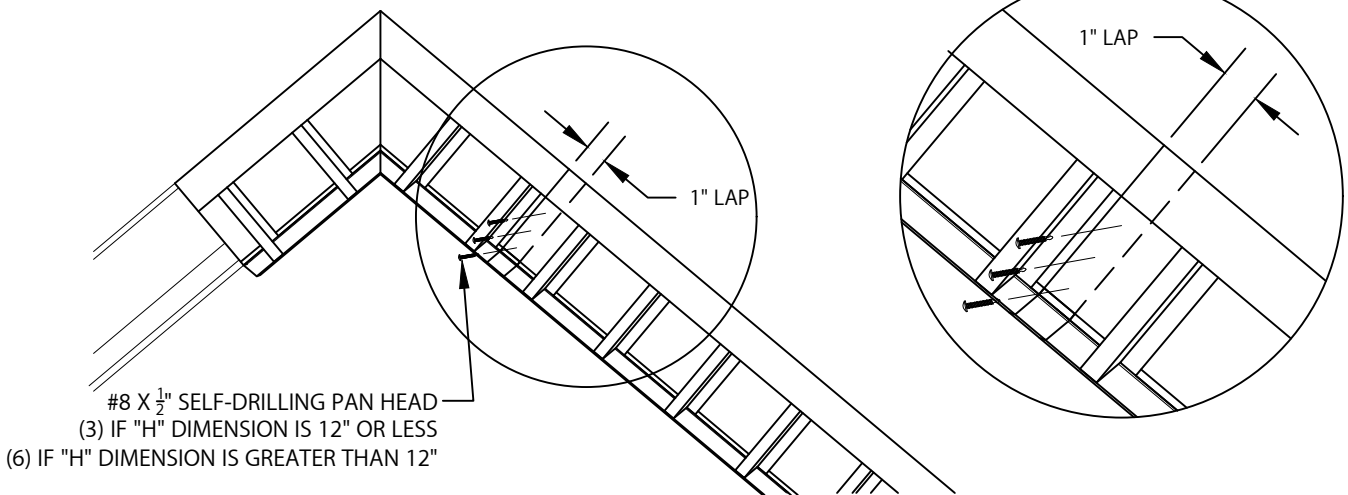

### 4. BACKER ASSEMBLY LAP JOINT

LAP ONE 12'-0" PIECE OF BACKER ASSEMBLY 1" OVER THE MITER BACKER ASSEMBLY AS SHOWN. FASTEN THE 24 GA. GALV. BACKER OF THE 12'-0" PIECE TO THE 24 GA. GALV. BACKER OF THE MITER USING #8 X ½" SELF-DRILLING PAN HEAD FASTENERS. USE 3 FASTENERS FOR "H" DIMENSIONS 12" OR LESS AND 6 FASTENERS FOR "H" DIMENSIONS GREATER THAN 12". FASTENERS CAN BE INSTALLED FROM FRONT TO BACK OR BACK TO FRONT, AS BEST FOR YOUR APPLICATION (FASTENERS SHOWN FROM FRONT TO BACK). NO FASTENERS NECESSARY AT THE CONTINUOUS ROOF FLANGE LAP JOINT.



Phone: 800-558-2162  
 Fax: 800-770-3934  
 www.metalera.com

DATE: 09/09/22	SHT.# 3 OF 7
DRN BY: MLM	
CKD BY: MM	DWG# 31127-7372

G

# HI-PERF RAKE FASCIA

WITH VERTICAL "Z" BRACKETS

INSTALLATION INSTRUCTIONS

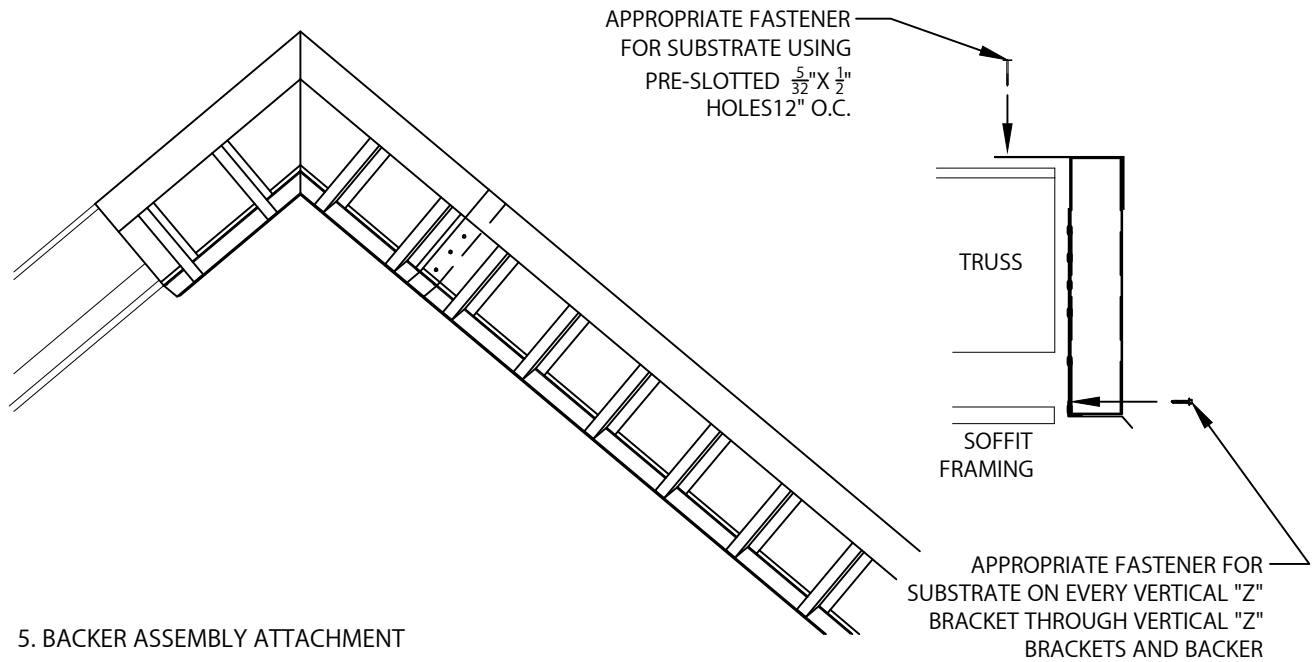

## 5. BACKER ASSEMBLY ATTACHMENT

ATTACH THE ROOF FLANGE OF THE BACKER ASSEMBLY TO THE TOP OF THE SHEATHING WITH AN APPROPRIATE FASTENER FOR THE SUBSTRATE USING THE PRE-SLOTTED  $\frac{5}{32}$ " X  $\frac{1}{2}$ " HOLES AT 12" O.C. ATTACH THE BACKER ASSEMBLY THROUGH THE VERTICAL "Z" BRACKETS AND BACKER USING APPROPRIATE FASTENER FOR SUBSTRATE ON EVERY VERTICAL "Z" BRACKET.

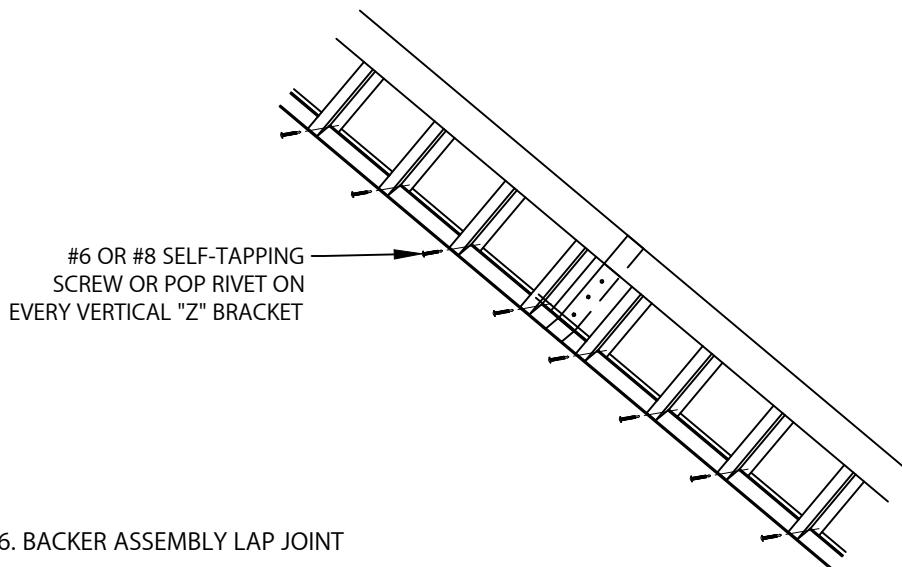

## 6. BACKER ASSEMBLY LAP JOINT

LAP ONE 12'-0" PIECE OF BACKER ASSEMBLY 1" OVER THE PREVIOUS BACKER ASSEMBLY AS SHOWN. FASTEN THE 24 GA. GALV. BACKER OF THE 12'-0" PIECE TO THE 24 GA. GALV. BACKER OF THE USING #8 X  $\frac{1}{2}$ " SELF-DRILLING PAN HEAD FASTENERS. USE 3 FASTENERS FOR "H" DIMENSIONS 12" OR LESS AND 6 FASTENERS FOR "H" DIMENSIONS GREATER THAN 12". FASTENERS CAN BE INSTALLED FROM FRONT TO BACK OR BACK TO FRONT, AS BEST FOR YOUR APPLICATION (FASTENERS SHOWN FROM FRONT TO BACK). NO FASTENERS NECESSARY AT THE CONTINUOUS ROOF FLANGE LAP JOINT.



Phone: 800-558-2162  
Fax: 800-770-3934  
www.metalera.com

DATE: 09/09/22

SHT.# 4 OF 7

DRN BY: MLM

CKD BY: MM

DWG# 31127-7372

G

# HI-PERF RAKE FASCIA

WITH VERTICAL "Z" BRACKETS

INSTALLATION INSTRUCTIONS

CONTINUE WITH STEPS 7-8 FOR LAP JOINT VERSION

GO TO STEP 9 FOR SPLICE PLATE VERSION

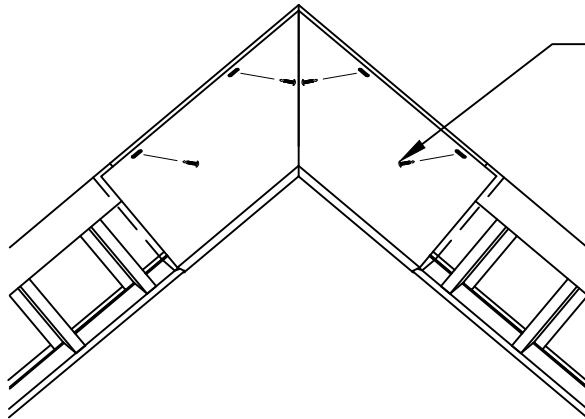

#6 OR #8 SELF-TAPPING  
SCREW OR POP RIVET AT  
EVERY PRE-SLOTTED  
 $\frac{5}{32}$ " X  $\frac{1}{2}$ " HOLE 12" O.C.

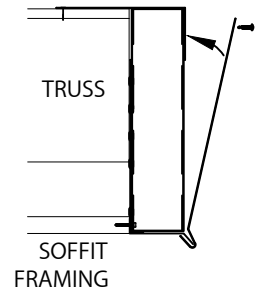

## 7. MITER FASCIA COVER ATTACHMENT - PEAK MITER SHOWN LAP JOINT VERSION

HOOK THE BOTTOM OF THE MITER FASCIA COVER UNDER THE DRIP END OF THE CLOSURE PLATE. ROTATE THE MITER FASCIA COVER AND FASTEN THE TOP OF THE MITER FASCIA COVER USING THE PRE-SLOTTED  $\frac{5}{32}$ " X  $\frac{1}{2}$ " HOLES AT 12" O.C. USING A #6 OR #8 SELF-TAPPING SCREW OR POP RIVET AT EVERY SLOTTED HOLE.

REFERENCE THE EAVE INSTALLATION INSTRUCTIONS FOR THE EAVE TO  
RAKE MITER FASCIA COVER ATTACHMENT

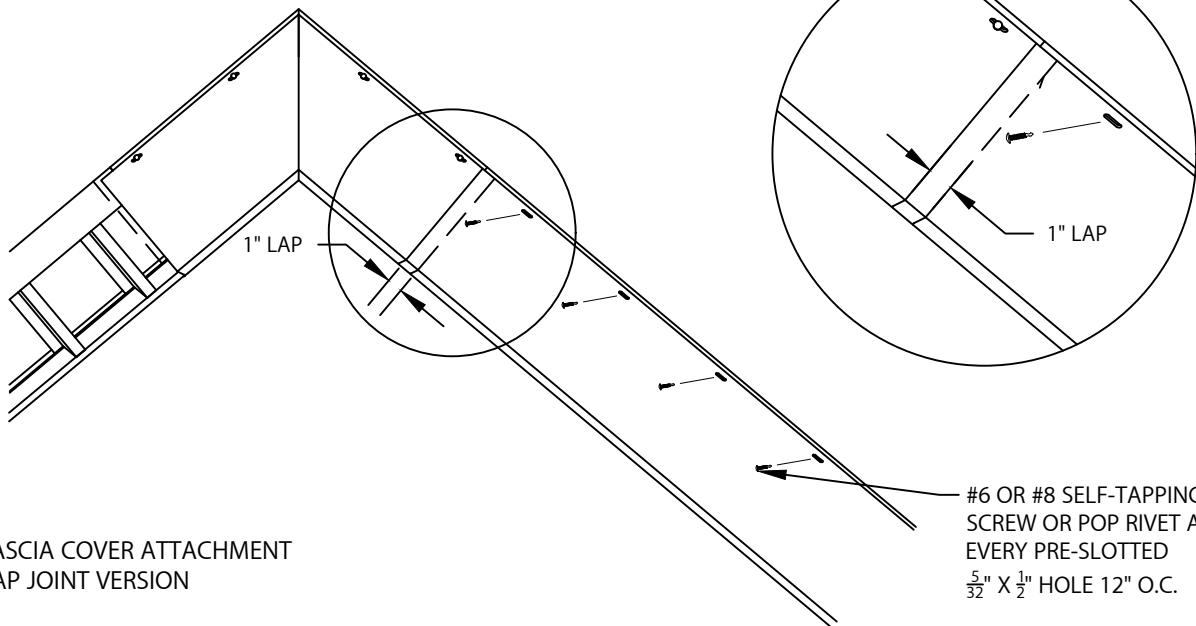

## 8. FASCIA COVER ATTACHMENT LAP JOINT VERSION

LAPPING ONE 12'-0" PIECE OF FASCIA COVER 1" OVER THE FASCIA COVER, HOOK THE BOTTOM OF THE FASCIA COVER UNDER THE DRIP END OF THE CLOSURE PLATE. ROTATE THE FASCIA COVER AND FASTEN THE TOP OF THE COVER USING THE PRE-SLOTTED  $\frac{5}{32}$ " X  $\frac{1}{2}$ " HOLES AT 12" O.C. USING A #6 OR #8 SELF-TAPPING SCREW OR POP RIVET AT EVERY SLOTTED HOLE. NO FASTENERS NECESSARY AT THE CONTINUOUS FASCIA COVER LAP JOINT.

#6 OR #8 SELF-TAPPING  
SCREW OR POP RIVET AT  
EVERY PRE-SLOTTED  
 $\frac{5}{32}$ " X  $\frac{1}{2}$ " HOLE 12" O.C.



Phone: 800-558-2162  
Fax: 800-770-3934  
www.metalera.com

DATE: 09/09/22

SHT.# 5 OF 7

DRN BY: MLM

CKD BY: MM

DWG# 31127-7372

G

# HI-PERF RAKE FASCIA

WITH VERTICAL "Z" BRACKETS

INSTALLATION INSTRUCTIONS

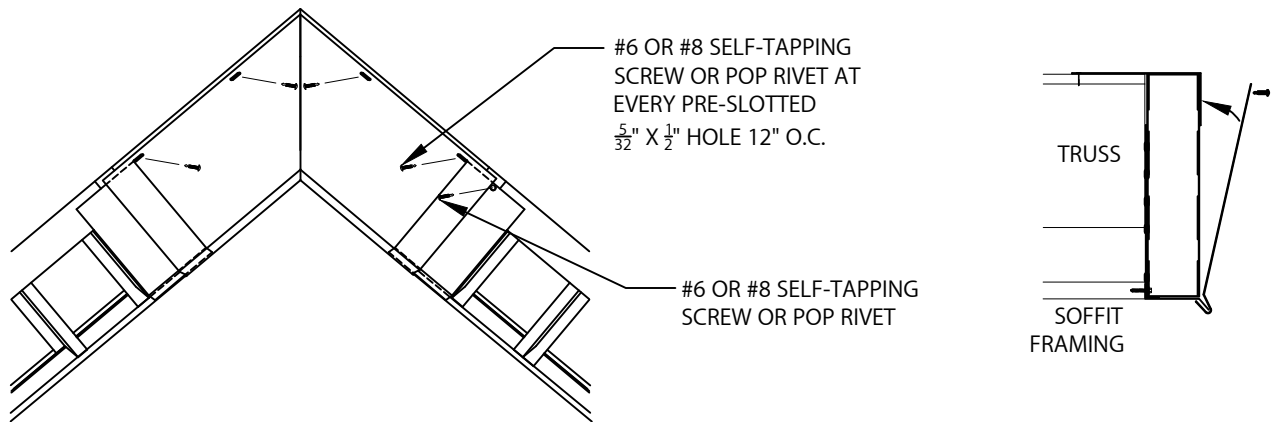

## 9. MITER FASCIA COVER ATTACHMENT - PEAK MITER SHOWN SPLICE PLATE VERSION

POSITION  $\frac{3}{8}$ " SPLICE PLATE CENTERED BEHIND FASCIA COVER AS SHOWN (MITER FASCIA COVER SHOWN). USING #6 OR #8 SELF-TAPPING SCREW OR POP RIVET FASTEN THE TOP OF THE EXPOSED END OF THE SPLICE PLATE TO THE FACE OF THE CONTINUOUS ROOF FLANGE AS SHOWN. HOOK THE BOTTOM OF THE MITER FASCIA COVER UNDER THE DRIP END OF THE CLOSURE PLATE. ROTATE THE MITER FASCIA COVER AND FASTEN THE TOP OF THE MITER FASCIA COVER USING THE PRE-SLOTTED  $\frac{5}{32}$ " X  $\frac{1}{2}$ " HOLES AT 12" O.C. USING A #6 OR #8 SELF-TAPPING SCREW OR POP RIVET AT EVERY SLOTTED HOLE.

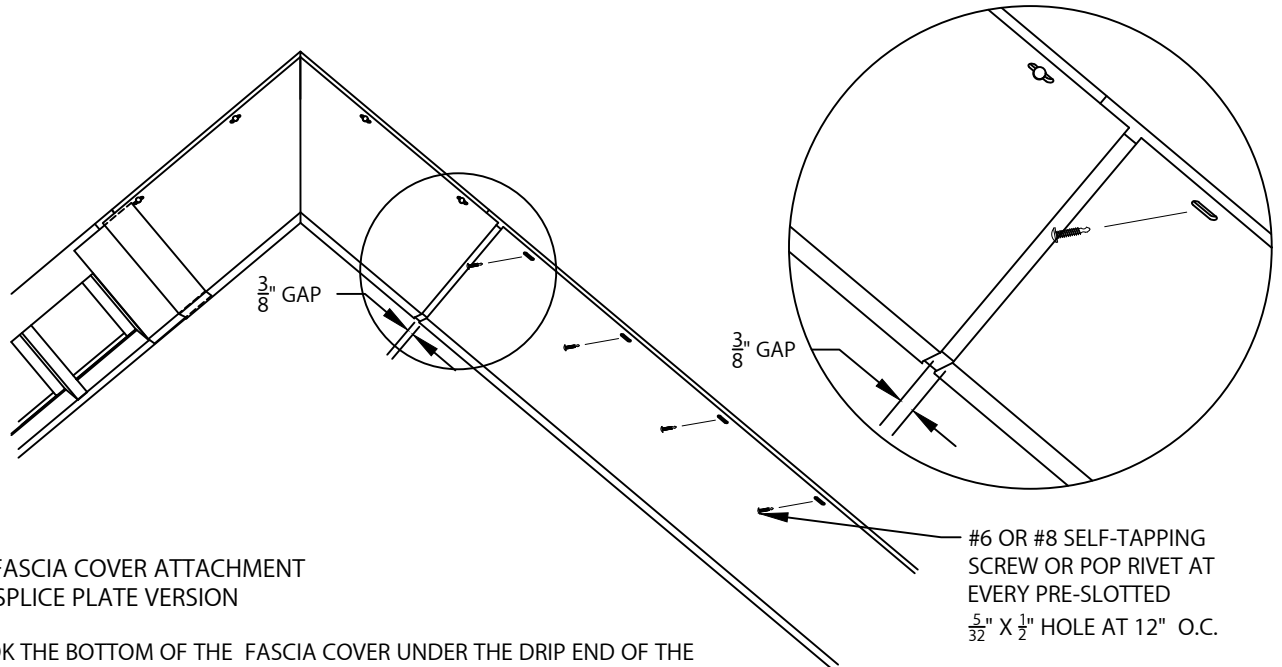

## 10. FASCIA COVER ATTACHMENT SPLICE PLATE VERSION

HOOK THE BOTTOM OF THE FASCIA COVER UNDER THE DRIP END OF THE CLOSURE PLATE. ROTATE THE FASCIA COVER AND FASTEN THE TOP OF THE COVER USING THE PRE-SLOTTED  $\frac{5}{32}$ " X  $\frac{1}{2}$ " HOLES AT 12" O.C. USING A #6 OR #8 SELF-TAPPING SCREW OR POP RIVET AT EVERY SLOTTED HOLE. LEAVE A  $\frac{3}{8}$ " GAP BETWEEN THE FASCIA COVERS TO ALLOW FOR THERMAL EXPANSION.



Phone: 800-558-2162  
Fax: 800-770-3934  
www.metalera.com

DATE: 09/09/22

SHT.# 6 OF 7

DRN BY: MLM

CKD BY: MM

DWG# 31127-7372

G

# HI-PERF RAKE FASCIA

WITH VERTICAL "Z" BRACKETS

INSTALLATION INSTRUCTIONS

## TYPICAL COMPONENT LIST

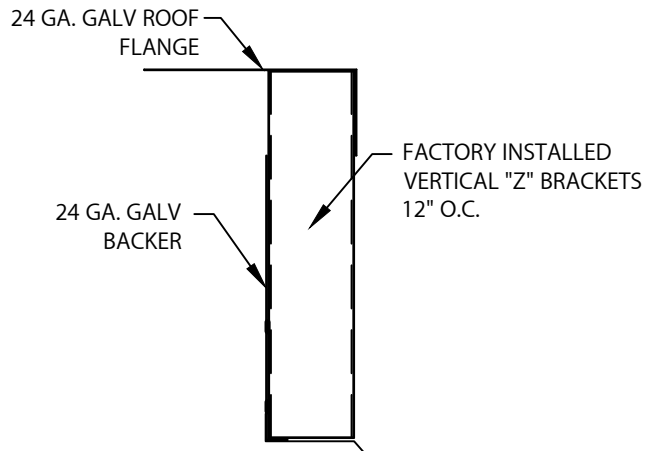

BACKER ASSEMBLY  
12'-0" LENGTHS:  
FACTORY ASSEMBLED 24 GA. GALV.  
ROOF FLANGE, 24 GA. GALV.  
BACKER, 24 GA. CLOSURE PLATE  
AND VERTICAL "Z" BRACKETS 12"  
O.C.



FASCIA COVER  
12'-0" LENGTHS



COVER SPLICE PLATE  
3 1/2" LENGTHS  
(WHEN APPLICABLE)

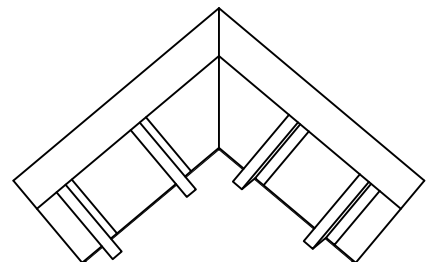

MITER BACKER ASSEMBLY:  
PEAK MITER SHOWN  
(WHEN APPLICABLE)

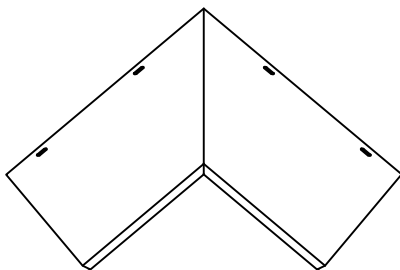

MITER FASCIA COVER:  
PEAK MITER SHOWN  
(WHEN APPLICABLE)



Phone: 800-558-2162  
Fax: 800-770-3934  
www.metalera.com

DATE: 09/09/22

SHT.# 7 OF 7

DRN BY: MLM

CKD BY: MM

DWG# 31127-7372

G