

REFERENCE DETAIL:

HI-PERF SYSTEM MITER

INSIDE EAVE TO RAKE VERSION

PATENT #7,721,489

RIGHT HAND MITER SHOWN

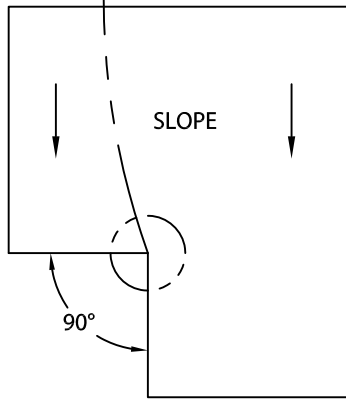
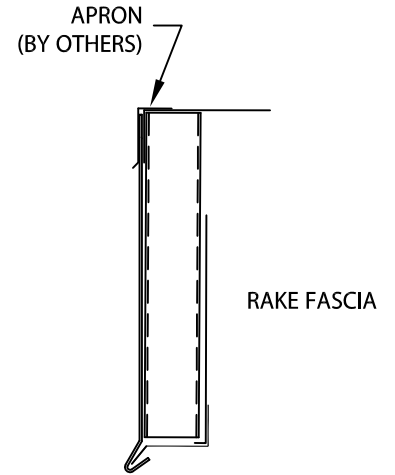
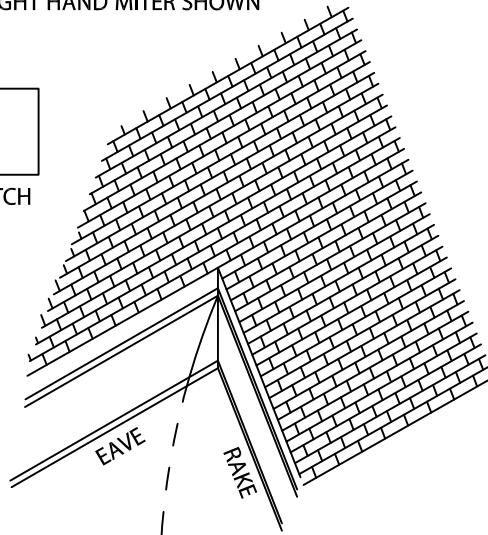
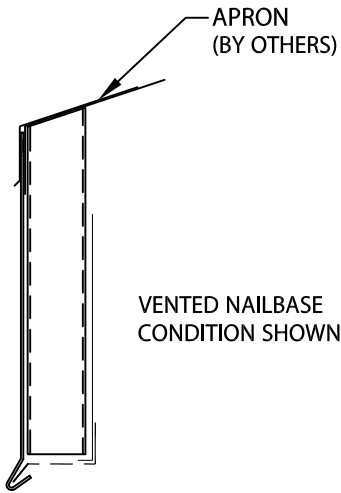
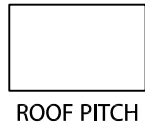

- SPECIFY REQUIRED CONDITION:
- VENTED NAILBASE
 - ATTIC VENTED
 - NON-VENTED

- SPECIFY REQUIRED CONDITION:
- RAKE FASCIA
 - RAKE PANEL

METAL-ERA CAN NOT BE RESPONSIBLE FOR OIL CANNING THAT MAY OCCUR IN LIGHT GAUGE MATERIALS ON LARGE FASCIA HEIGHTS - CALL FOR RECOMMENDATIONS

COVER:

- 24 GA. GALV. STEEL
 - .040" ALUMINUM
 - .063" ALUMINUM
 - 22 GA. GALV. STEEL
 - .050" ALUMINUM
 - Other _____
- COLOR: _____ FINISH: _____

Fabrication will proceed only after receipt of signed print approval.

Print Approval:

Architect and/or contractor shall verify all dimensions, sizes and quantities. All products to be installed in strict accordance with Metal-Era's printed instructions.

Approved by: _____

Date: _____

PERFORATED CLOSURE:

- 24 GA. GALV. STEEL BONE WHITE
- 24 GA. GALV. STEEL DARK BRONZE
- 24 GA. GALV. STEEL SANDSTONE
- 24 GA. GALV. STEEL SLATE GRAY
- PERFORATIONS NOT REQUIRED (NON-VENTED ONLY)

QUANTITIES:

_____ LEFT HAND MITERS _____ RIGHT HAND MITERS

PROJECT:

ARCHITECT:

CONTRACTOR:

REPRESENTATIVE:



Phone: 800-558-2162
Fax: 800-770-3934
www.metalera.com

DATE: 09/01/22

DRN BY: MLM

CKD BY: MM

SHT.# ____ OF ____

DWG# 31018-7524

E